

Audio System - '09-11 models

Auxiliary Jack Assembly Replacement

With navigation

1. Remove the center lower trim (A) (see page 20-100).

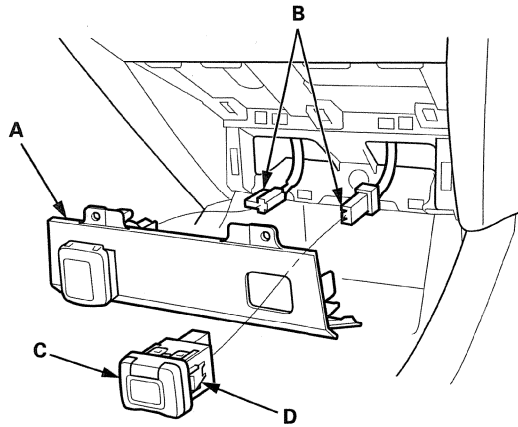

2. Disconnect the connectors (B) from the auxiliary jack (C) and the accessory socket.
3. Push out the auxiliary jack (C) from the center lower trim, while pressing lock tabs (D).
4. Install the auxiliary jack in the reverse order of removal.

Speaker Test/Replacement

Front/Rear Door Speaker

1. Remove the door panel:
 - Front (see page 20-6)
 - Rear (see page 20-18)
2. Remove the bolt (A). Then lift the speaker (B) straight up to release the lower clips (C).

NOTICE

If you pull the speaker out too far from the door, you will damage the lower clips.

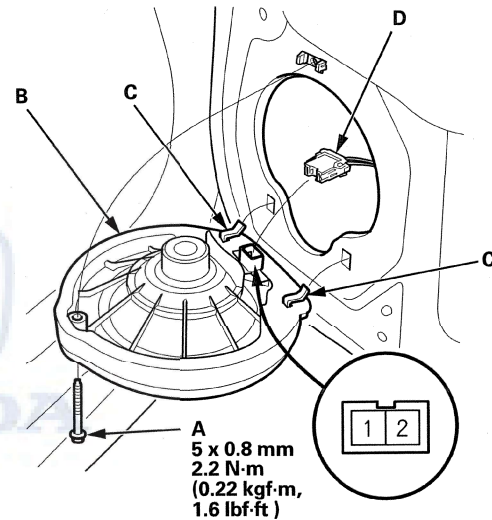

3. Disconnect the 2P connector (D), and remove the speaker.
4. Measure the resistance between terminals No. 1 and No. 2. There should be about 4 Ω .
5. If the resistance is not as specified, replace the door speaker.



Tweeter

1. Insert a flat-tip screwdriver in the groove (A), and carefully pry the tweeter grille (B).

NOTE: Be careful not to damage the tweeter grille and the dashboard.

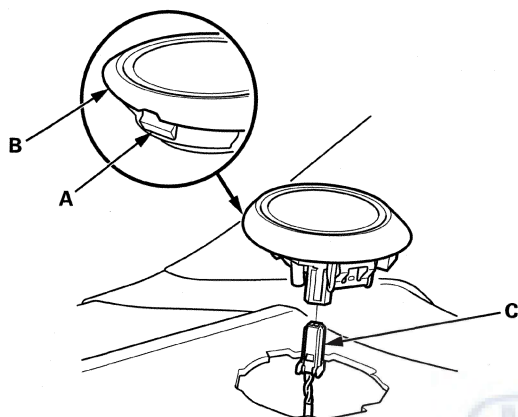

2. Disconnect the 2P connector (C) from the tweeter.
3. Check the capacitor condition. If any malfunction is found, replace the tweeter.

4. Remove the tweeter speaker (A) from the speaker grille (B).

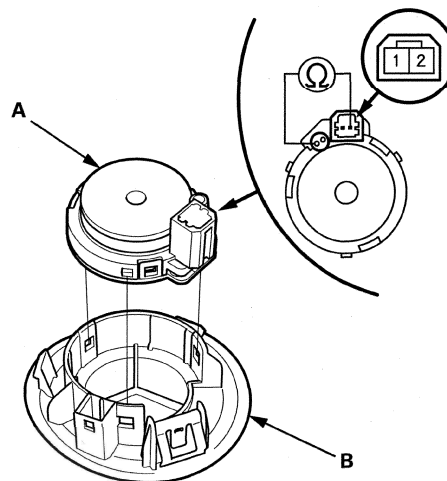

5. Measure the resistance between the soldered joint and terminal No. 2. There should be about $4\ \Omega$.
6. If the resistance is not as specified, replace the tweeter speaker.
7. Install the tweeter speaker in the reverse order of removal.

NOTE: Align the tweeter speaker connector with the cut-out on the speaker grille.