

Body Electrical

Body Electrical

Special Tools	22-2
General Troubleshooting Information .	22-3

Relay and Control Unit Locations

Engine Compartment	22-7
Dashboard	22-8
Seat	22-11
Door	22-12

Connectors and Harnesses

Connector Index	22-13
Connector to Harness Index	22-14

Fuse/Relay Boxes

Connector to Fuse/Relay Box Index	22-53
--	-------

Power Distribution

Fuse to Components Index	22-57
--------------------------------	-------

Ground Distribution

Ground to Components Index	22-62
----------------------------------	-------

Under-dash Fuse/Relay Box

* Removal and Installation	22-63
----------------------------------	-------

Battery

Battery Test	22-65
Battery Terminal Disconnection and Reconnection	22-66
Battery Removal and Installation	22-67

Relays

Power Relay Test	22-68
------------------------	-------

Ignition Switch

Component Location Index	22-70
Circuit Diagram	22-71
* Key Interlock System Circuit Troubleshooting	22-72
* Key Interlock Solenoid Test	22-73
Park Pin Switch Test	22-74
* Ignition Switch Test	22-75
* Ignition Switch Replacement	22-75

Multiplex Integrated Control System

Component Location Index	22-76
General Troubleshooting Information .	22-77
DTC Troubleshooting Index	22-80
System Description	22-82
Troubleshooting	
B-CAN System Diagnosis Test Mode A	22-95
B-CAN System Diagnosis Test Mode B	22-96
B-CAN System Diagnosis Test Mode C	22-97

B-CAN System Diagnosis Test Mode D	22-98
B-CAN System Diagnosis Test Mode 1 and Test Mode 2 (without the HDS)	22-99
Sleep and Wake-up Mode Test	22-102
Circuit Diagram	22-103
DTC Troubleshooting	22-104
MICU Input Test	22-109

Keyless/Power Door

Locks/Security System

Component Location Index	22-111
System Description	22-113
Circuit Diagram	22-114
DTC Troubleshooting	22-118
Symptom Troubleshooting Index	22-122
Symptom Troubleshooting	22-123
MICU Input Test	22-125
Door Lock Actuator Test	22-131
Tailgate Lock Actuator Test	22-133
Door Lock Knob Switch Test	22-133
Door Key Cylinder Switch Test	22-135
Security Horn Test/Replacement	22-135
Security Hood Switch Test	22-136
Transmitter Test	22-136
Tripped Sensor History	22-139

Horns

Component Location Index	22-140
Circuit Diagram - With Security System	22-141
Without Security System	22-142
Horn Test/Replacement	22-143
Horn Switch Test	22-143

Exterior Lights

Component Location Index	22-145
System Description	22-148
Circuit Diagram	22-150
Back-up Lights	22-152
Brake Lights	22-153
Fog Lights	22-154
DTC Troubleshooting	22-155
MICU Input Test	22-162
Combination Light Switch Test/Replacement	22-166
Headlight Adjustment	22-168
Headlight Replacement	22-169
Bulb Replacement	22-169
Fog Light Replacement	22-172
Fog Light Adjustment	22-172
Taillight Replacement	22-173
License Plate Light Replacement	22-173
High Mount Brake Light Replacement .	22-174
Brake Pedal Position Switch Test	22-174

Turn Signal/Hazard Warning Lights

Component Location Index	22-175
Circuit Diagram	22-176
DTC Troubleshooting	22-178
MICU Input Test	22-180
Hazard Warning Switch Test/Replacement	22-183

Interior Lights

Component Location Index	22-184
Circuit Diagram	22-185
Front Individual Map Light Test/Replacement	22-186
Ceiling Light Test/Replacement	22-187
Cargo Area Light Test/Replacement ...	22-187
Tailgate Latch Switch Test	22-188

Entry Lights Control System

Component Location Index	22-189
Circuit Diagram	22-190
MICU Input Test	22-191
Ignition Key Switch Test	22-196

Power Windows

Component Location Index	22-197
System Description	22-198
Resetting the Power Window Control Unit	22-199
Circuit Diagram	22-200
Power Window Master Switch Input Test	22-202
Driver's Power Window Motor Test ...	22-205
Front Passenger's Power Window Motor Test	22-206
Rear Power Window Motor Test	22-207
Power Window Master Switch Test ...	22-208
Passenger's Power Window Switch Test	22-209
Power Window Master Switch Replacement	22-210
Passenger's Power Window Switch Replacement	22-211

Wipers/Washers

Component Location Index	22-212
Circuit Diagram - Windshield	22-214
Rear Window	22-215
DTC Troubleshooting	22-216
MICU Input Test	22-222
Wiper/Washer Switch Test/Replacement	22-226
Wiper Motor Test	22-227
Washer Motor Test	22-228
Washer Fluid Level Switch Test	22-228
Wiper Motor Replacement	22-229
Wiper Arm Replacement	22-231
Washer Reservoir Replacement	22-231
Wiper Blade Replacement	22-232
Wiper Arm/Nozzle Adjustment	22-234

Washer Tube Replacement	22-235
-------------------------------	--------

Gauges

Component Location Index	22-237
Self-diagnostic Function	22-239
Circuit Diagram	22-242
DTC Troubleshooting	22-247
Gauge Control Module Input Test	22-254
Rewriting the ODO Data and Transferring the Maintenance Minder Data to a New Gauge Control Module	22-257
Gauge Control Module Replacement ..	22-258

Reminder Systems

Component Location Index	22-259
Circuit Diagram	22-260
Control Unit Input Test	22-262

Accessory Power Sockets

Component Location Index	22-266
Circuit Diagram	22-267
Accessory Power Socket Test/Replacement	22-268

Power Mirrors

Component Location Index	22-269
Circuit Diagram	22-270
Function Test	22-272
Power Mirror Switch Test/Replacement	22-273
Power Mirror Actuator Test	22-274
Power Mirror Actuator Replacement ...	22-274

Rear Window Defogger

Component Location Index	22-277
Circuit Diagram	22-278
Switch Test/Replacement	22-279
Function Test	22-279
Defogger Wire Repair	22-280

Immobilizer System

Component Location Index	22-281
System Description	22-283
Circuit Diagram	22-284
DTC Troubleshooting	22-285
Symptom Troubleshooting Information	22-287
Symptom Troubleshooting Index	22-289
Symptom Troubleshooting	22-290
System Check	22-292
Status Log	22-294
Immobilizer-Keyless Control Unit Input Test	22-295
Immobilizer Key Registration	22-297
Immobilizer-Keyless Control Unit Replacement	22-298



Wipers/Washers

Component Location Index

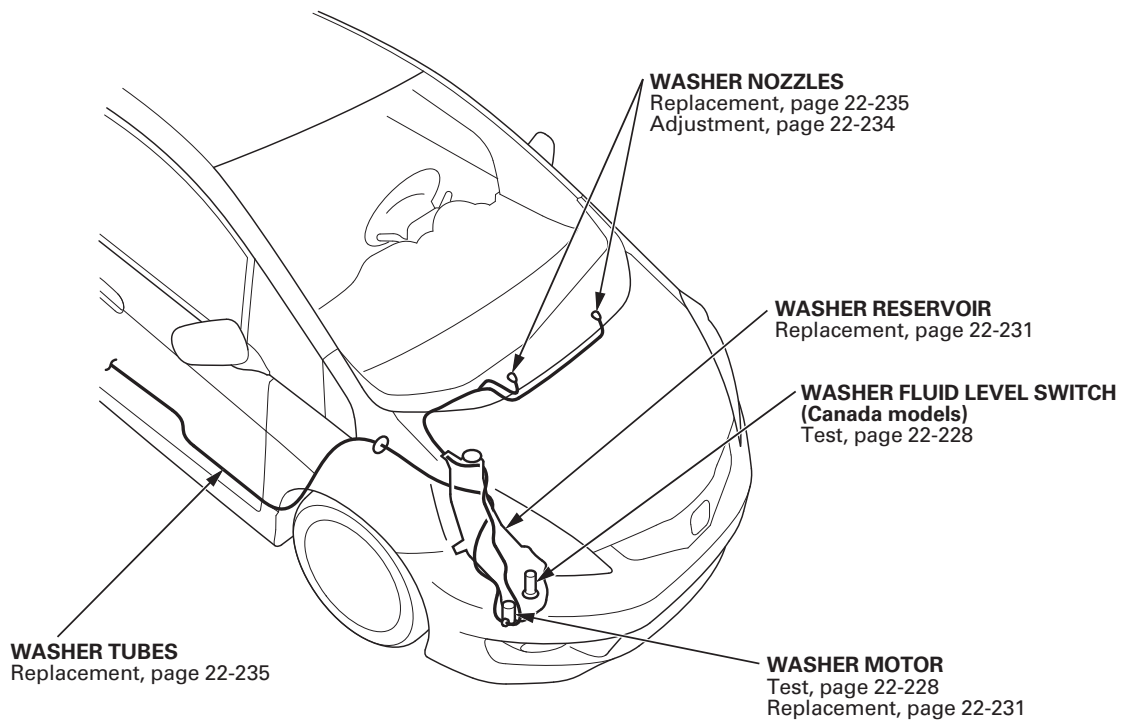
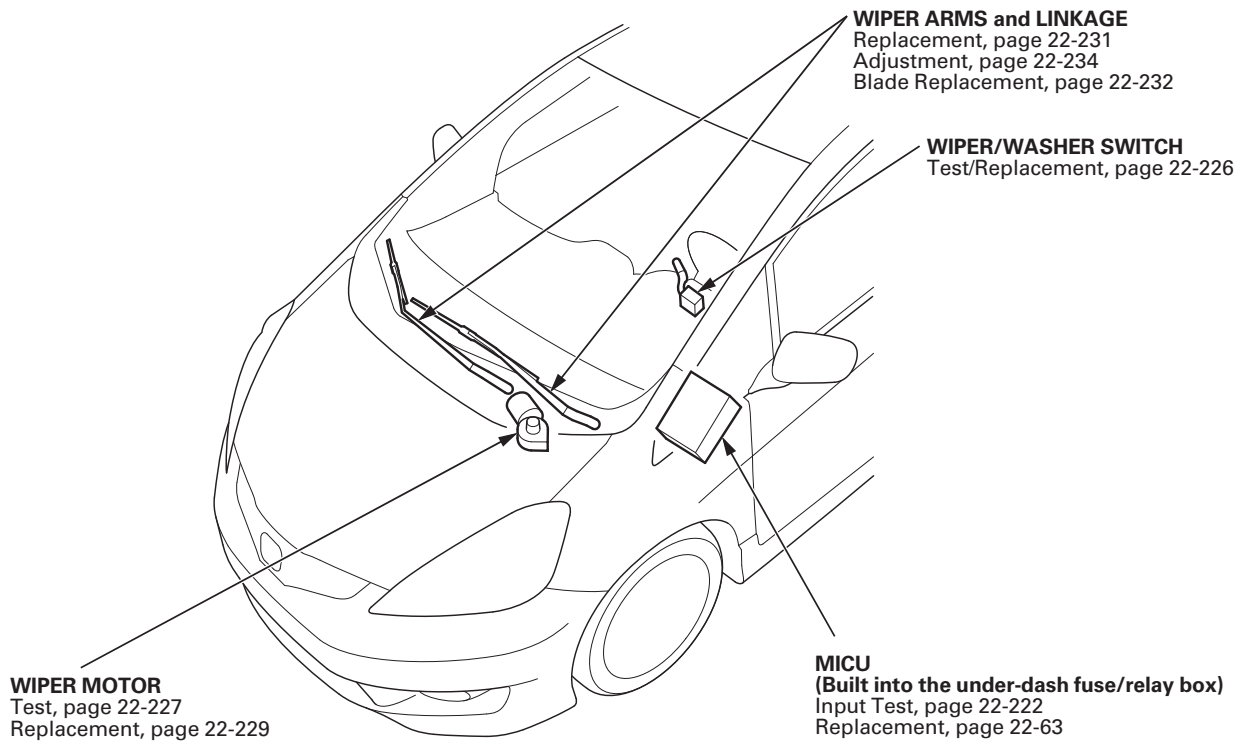

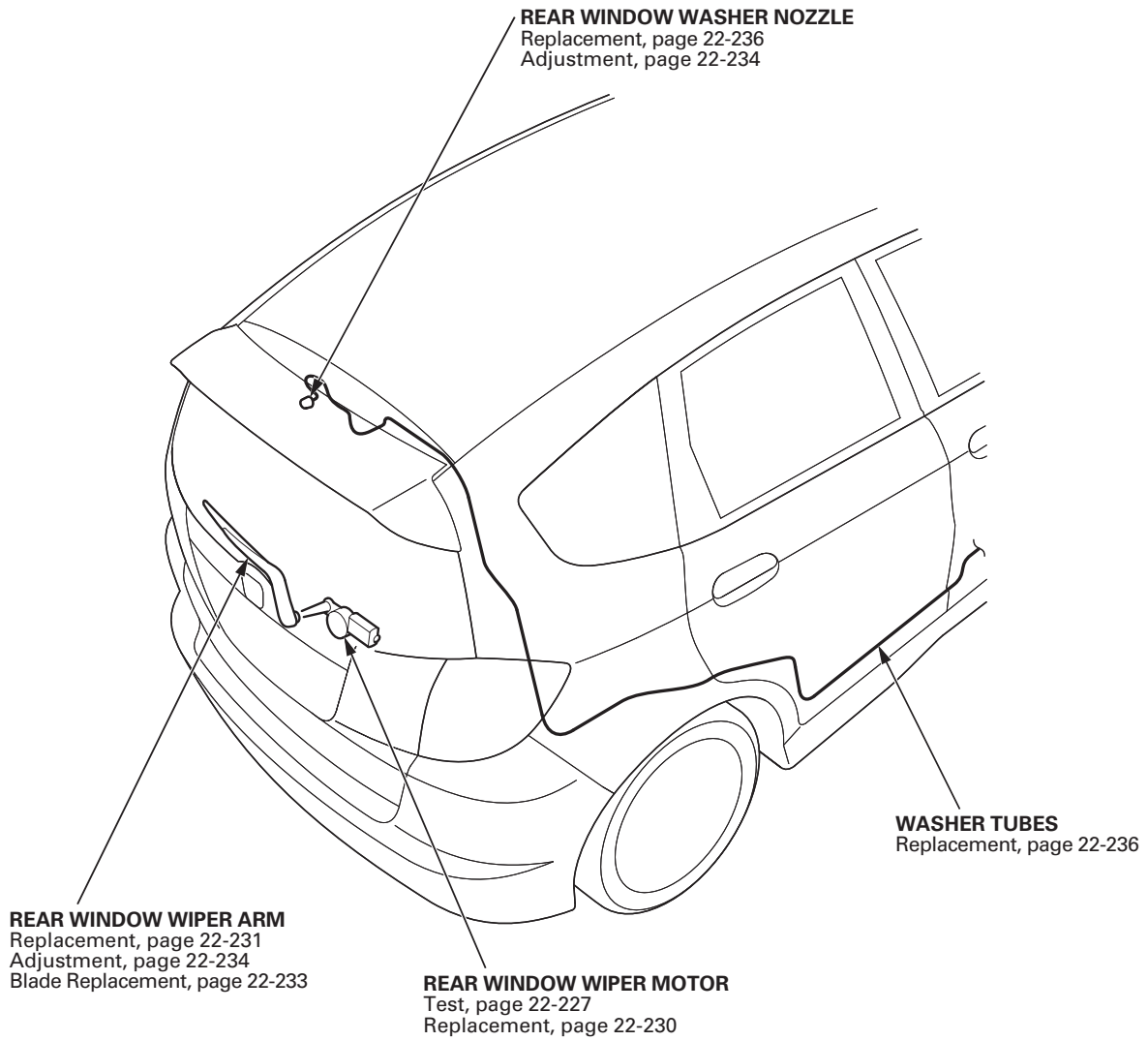

Wipers/Washers

Circuit Diagram - Windshield

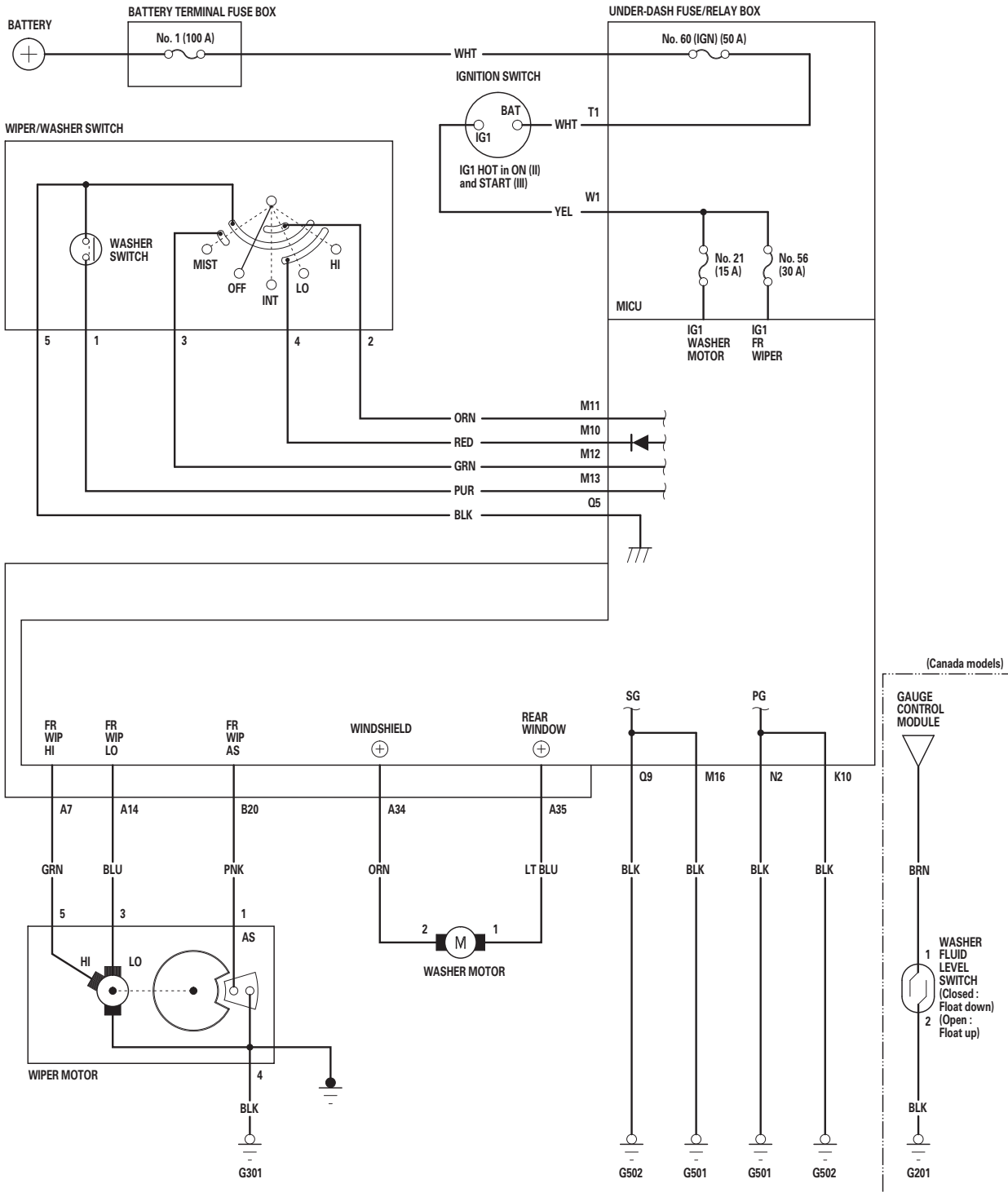

Circuit Diagram - Rear Window

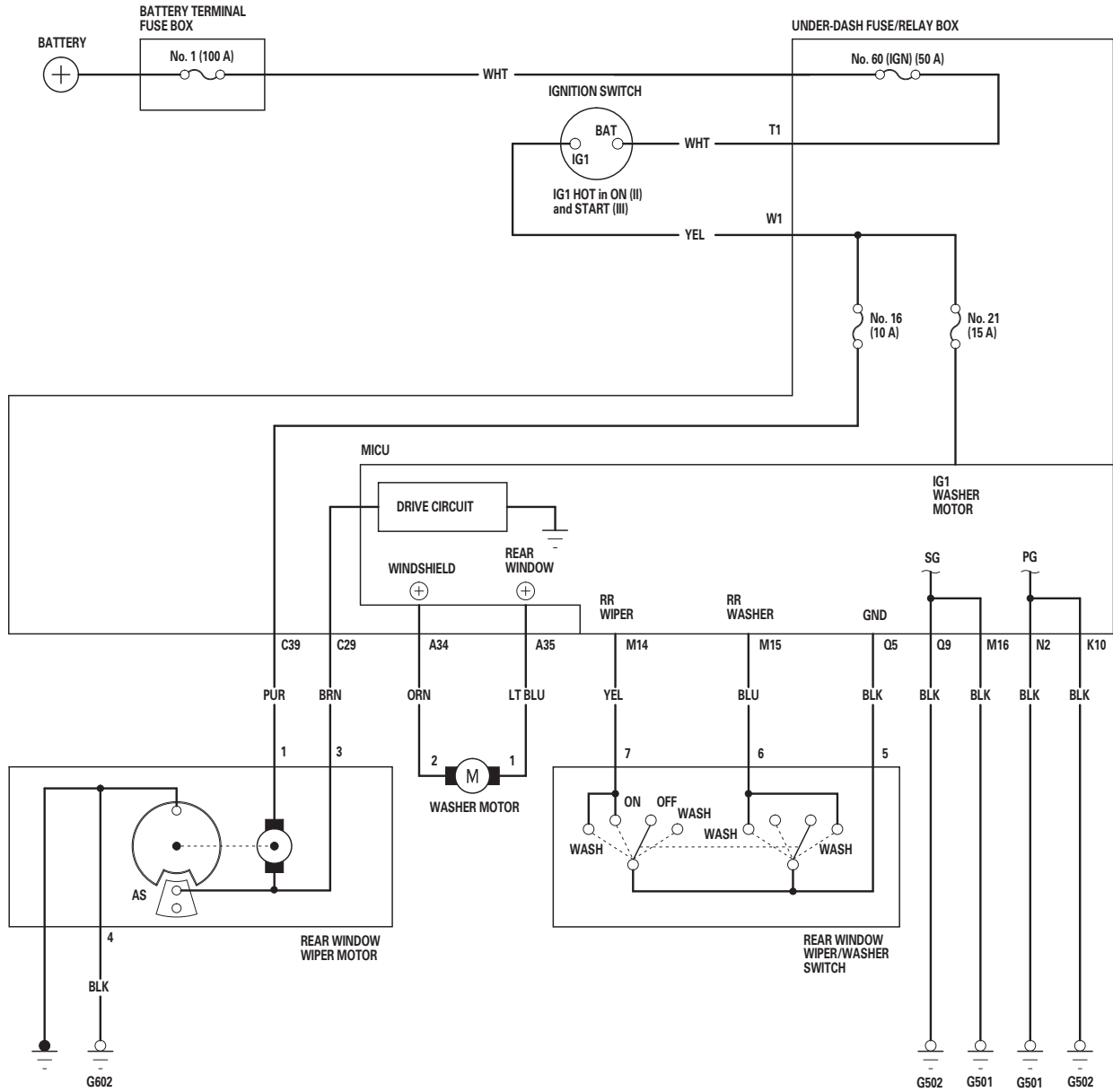

Wipers/Washers

DTC Troubleshooting

DTC B1028: Rear Wiper Auto Stop Switch Malfunction

NOTE: If you are troubleshooting multiple DTC's, be sure to follow the instruction in B-CAN System Diagnosis Test Mode A (see page 22-95).

1. Clear the DTCs with the HDS.
2. Turn the ignition switch to LOCK (0) and then back to ON (II).
3. Operate the rear window wiper for at least 15 seconds, then turn the rear window wiper switch OFF.
4. Check for DTCs with the HDS.

Is DTC B1028 indicated?

YES—Go to step 5.

NO—Intermittent failure, the system is OK at this time. Check for loose or poor connections. ■

5. Check the No. 16 (10 A) fuse in the under-dash fuse/relay box.

Is the fuse OK?

YES—Go to step 6.

NO—Replace the fuse, and recheck the system. ■

6. Disconnect the rear window wiper motor 4P connector.
7. Turn the ignition switch to ON (II).
8. Measure the voltage between rear window wiper motor 4P connector terminal No. 1 and body ground.

REAR WINDOW WIPER MOTOR 4P CONNECTOR

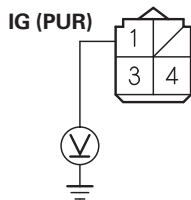

Wire side of female terminals

Is there battery voltage?

YES—Go to step 9.

NO—Repair open in the wire between the under-dash fuse/relay box and the rear window wiper motor. ■

9. Check for continuity between rear window wiper motor 4P connector terminal No. 4 and body ground.

REAR WINDOW WIPER MOTOR 4P CONNECTOR

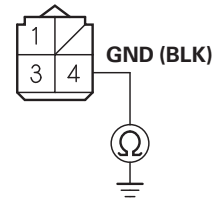

Wire side of female terminals

Is there continuity?

YES—Go to step 10.

NO—Repair open in the wire between rear window wiper motor 4P connector terminal No. 4 and body ground (G602). ■

10. Do the rear window wiper motor test (see page 22-227).

Is the rear window wiper motor OK?

YES—Go to step 11.

NO—Replace the rear window wiper motor. ■

11. Disconnect under-dash fuse/relay box connector C.
12. Measure the voltage between rear window wiper motor 4P connector terminal No. 3 and body ground.

REAR WINDOW WIPER MOTOR 4P CONNECTOR

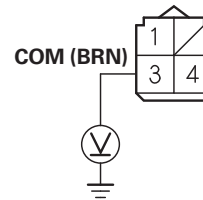

Wire side of female terminals

Is there battery voltage?

YES—Repair short to power in the wire between the rear window wiper motor and the under-dash fuse/relay box. ■

NO—Go to step 13.

13. Check for continuity between rear window wiper motor 4P connector terminal No. 3 and body ground.

REAR WINDOW WIPER MOTOR 4P CONNECTOR

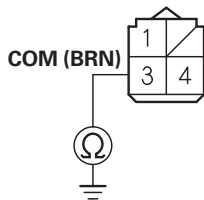

Wire side of female terminals

Is there continuity?

YES—Repair short to ground in the wire between the rear window wiper motor and the under-dash fuse/relay box. ■

NO—Go to step 14.

14. Check for continuity between under-dash fuse/relay box connector C (49P) terminal No. 29 and rear window wiper rear window wiper motor 4P connector terminal No. 3.

REAR WINDOW WIPER MOTOR 4P CONNECTOR

Wire side of female terminals

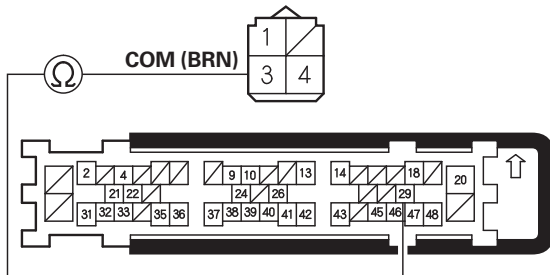

UNDER-DASH FUSE/RELAY BOX CONNECTOR C (49P)

Wire side of female terminals

Is there continuity?

YES—Faulty MICU, replace the under-dash fuse/relay box (see page 22-63). ■

NO—Repair open in the wire between the rear window wiper motor and the under-dash fuse/relay box. ■

DTC B1077: Wiper (As) Signal Error

NOTE: If you are troubleshooting multiple DTC's, be sure to follow the instruction in B-CAN System Diagnosis Test Mode A (see page 22-95).

1. Clear the DTCs with the HDS.
2. Turn the ignition switch to LOCK (0) and then back to ON (II).
3. Turn the wiper switch to LOW or HIGH for at least 15 seconds, then turn the switch OFF.

Does the wiper motor work?

YES—Go to step 4.

NO—Go to step 13.

4. Check for DTCs with the HDS.

Is DTC B1077 indicated?

YES—Go to step 5.

NO—Intermittent failure, the system is OK at this time. Check for loose or poor connections. ■

5. Turn the ignition switch to LOCK (0).
6. Do the wiper motor test (see page 22-227).

Does the wiper motor run and does it pulse normally?

YES—Go to step 7.

NO—Replace the wiper motor, and recheck. ■

7. Disconnect the wiper motor 5P connector.
8. Disconnect under-dash fuse/relay box connector B (36P).

(cont'd)

Wipers/Washers

DTC Troubleshooting (cont'd)

9. Check for continuity between wiper motor 5P connector terminal No. 1 and under-dash fuse/relay box connector B (36P) terminal No. 20.

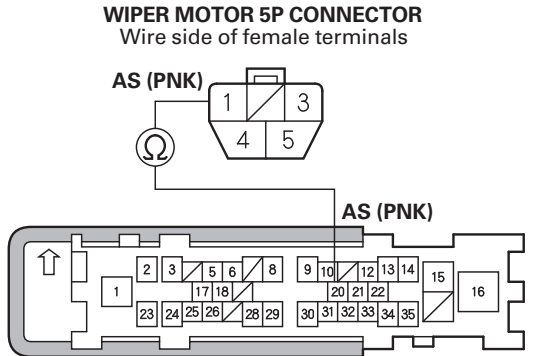

Is there continuity?

YES—Go to step 10.

NO—Repair open in the PNK wire.■

10. Check for continuity between wiper motor 5P connector terminal No. 1 and body ground.

WIPER MOTOR 5P CONNECTOR

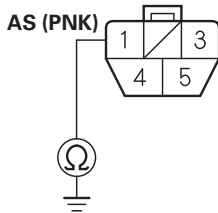

Wire side of female terminals

Is there continuity?

YES—Repair short to ground in the PNK wire.■

NO—Go to step 11.

11. Turn the ignition switch to ON (II).

12. Measure the voltage between wiper motor 5P connector terminal No. 1 and body ground.

WIPER MOTOR 5P CONNECTOR

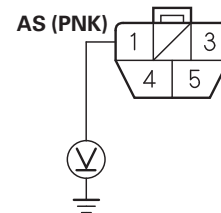

Wire side of female terminals

Is there voltage?

YES—Repair short to ground in the PNK wire.■

NO—Faulty MICU; replace the under-dash fuse/relay box (see page 22-63).■

13. Turn the ignition switch to LOCK (0).

14. Check the No. 56 (30 A) fuse in the under-dash fuse/relay box.

Is the fuse OK?

YES—Go to step 15.

NO—Replace the fuse, and recheck the system.■

15. Do the wiper motor test (see page 22-227).

Does the wiper motor run normally?

YES—Go to step 16.

NO—Replace the wiper motor and recheck.■

16. Disconnect under-dash fuse/relay box connector A (36P) and the wiper motor 5P connector.

17. Check for continuity between under-dash fuse/relay box connector A (36P) terminals and the wiper motor 5P connector terminals as shown:

Under-dash fuse/relay box connector A (36P)	Wiper motor 5P connector
7	5
14	3

WIPER MOTOR 5P CONNECTOR
Wire side of female terminals

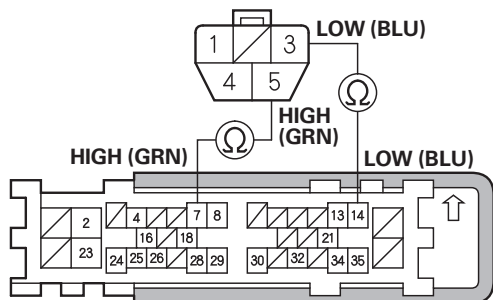

UNDER-DASH FUSE/RELAY BOX CONNECTOR A (36P)
Wire side of female terminals

Is there continuity?

YES—Go to step 18.

NO—Repair open in the BLU (LOW) or GRN (HIGH) wire. ■

18. Check for continuity between wiper motor 5P connector terminal No. 4 and body ground.

WIPER MOTOR 5P CONNECTOR

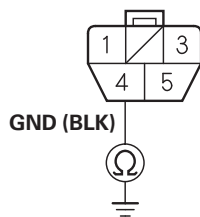

Wire side of female terminals

Is there continuity?

YES—Faulty MICU; replace the under-dash fuse/relay box (see page 22-63). ■

NO—Repair an open in the BLK wire or poor ground (G301). ■

DTC B1281: Wiper Switch MIST Position Circuit Malfunction

DTC B1282: Wiper Switch INT Position Circuit Malfunction

DTC B1283: Wiper Switch LOW Position Circuit Malfunction

DTC B1284: Wiper Switch HIGH Position Circuit Malfunction

NOTE: If you are troubleshooting multiple DTC's, be sure to follow the instruction in B-CAN System Diagnosis Test Mode A (see page 22-95).

1. Clear the DTCs with the HDS.
2. Turn the ignition switch to LOCK (0) and then back to ON (II).
3. Operate each wiper switch position, then turn the wiper/washer switch OFF.
4. Check for DTCs with the HDS.

Is DTC B1281, B1282, B1283, or B1284 indicated?

YES—Go to step 5.

NO—Intermittent failure, the system is OK at this time. Check for loose or poor connections. ■

5. Select WIPERS from the BODY ELECTRICAL menu, and enter DATA LIST.
6. Check each wiper switch position value with the DATA LIST menu.

When the wiper switch is OFF:

Data List	Value
Wiper Switch (LOW)	OFF
Wiper Switch (HIGH)	OFF
Wiper Switch (MIST)	OFF
Wiper Switch (INT)	OFF

Are all data list values correct?

YES—Go to step 15.

NO—Go to step 7.

(cont'd)

Wipers/Washers

DTC Troubleshooting (cont'd)

7. Turn the ignition switch to LOCK (0).
8. Disconnect the wiper/washer switch 8P connector.
9. Turn the ignition switch to ON (II).
10. Select WIPERS from the BODY ELECTRICAL menu.
11. Check each wiper switch position value with the DATA LIST menu.

Data List	Value
Wiper Switch (LOW)	OFF
Wiper Switch (HIGH)	OFF
Wiper Switch (MIST)	OFF
Wiper Switch (INT)	OFF

Are all data list values correct?

YES—Replace the wiper/washer switch (see page 22-226). ■

NO—Go to step 12.

12. Turn the ignition switch to LOCK (0).
13. Disconnect under-dash fuse/relay box connector M (34P).
14. Check for continuity between under-dash fuse/relay box connector M (24P) terminals No. 10, No. 11, and No. 12 and body ground.

UNDER-DASH FUSE/RELAY BOX CONNECTOR M (34P)

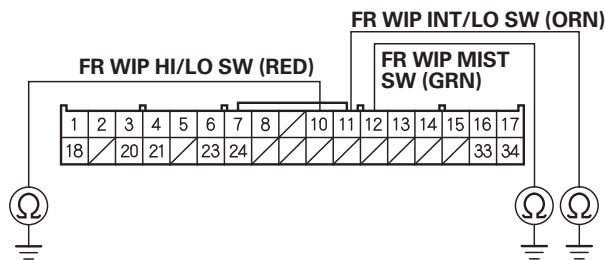

Wire side of female terminals

Is there continuity?

YES—Repair short to ground in the wires. ■

NO—Faulty MICU, replace the under-dash fuse/relay box (see page 22-63). ■

15. Check each wiper switch position value with the DATA LIST menu.

When the wiper switch is ON (LOW):

Data List	Value
Wiper Switch (LOW)	ON

When the wiper switch is ON (HIGH):

Data List	Value
Wiper Switch (HIGH)	ON

When the wiper switch is MIST:

Data List	Value
Wiper Switch (MIST)	ON

When the wiper switch is INT:

Data List	Value
Wiper Switch (INT)	ON

Are all data list values correct?

YES—Faulty MICU, replace the under-dash fuse/relay box (see page 22-63). ■

NO—Go to step 16.

16. Turn the ignition switch to LOCK (0).
17. Do the wiper/washer switch test (see page 22-226).

Is the wiper/washer switch OK?

YES—Go to step 18.

NO—Replace the wiper/washer switch. ■

18. Disconnect under-dash fuse/relay box connectors M (34P) and Q (16P).

19. Check for continuity between under-dash fuse/relay box connector M (34P) terminals and the wiper/washer switch 8P connector terminals as shown:

Under-dash fuse/relay box connector M (34P)	Wiper/wash switch 8P connector
10	4
11	2
12	3

Under-dash fuse/relay box connector Q (16P)	Wiper/wash switch 8P connector
5	5

UNDER-DASH FUSE/RELAY BOX CONNECTOR M (34P)
Wire side of female terminals

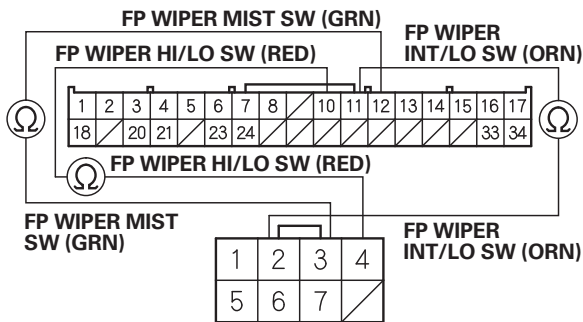

WIPER/WASHER SWITCH 8P CONNECTOR
Wire side of female terminals

UNDER-DASH FUSE/RELAY BOX CONNECTOR Q (16P)
Wire side of female terminals

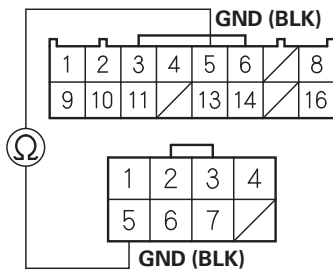

WIPER/WASHER SWITCH 8P CONNECTOR
Wire side of female terminals

Is there continuity?

YES—Faulty MICU, replace the under-dash fuse/relay box (see page 22-63). ■

NO—Repair open in the wires. ■

Wipers/Washers

MICU Input Test

NOTE:

- Before performing the input tests, check the No. 16 (10 A), No. 21 (15 A), and No. 56 (30 A) fuse in the under-dash fuse/relay box.
- If there is malfunction of the rear window wiper operation, and no DTCs are detected, check the rear window wiper motor and an open in the ground circuit of the rear window wiper (see step 9 on page 22-216).

1. Turn the ignition switch to LOCK (0).
2. Remove the fuse access panel (see page 20-92).
3. Disconnect under-dash fuse/relay box connectors A, B, C, K, M, N, Q, and W.

NOTE: All connector views are shown from wire side of female terminals.

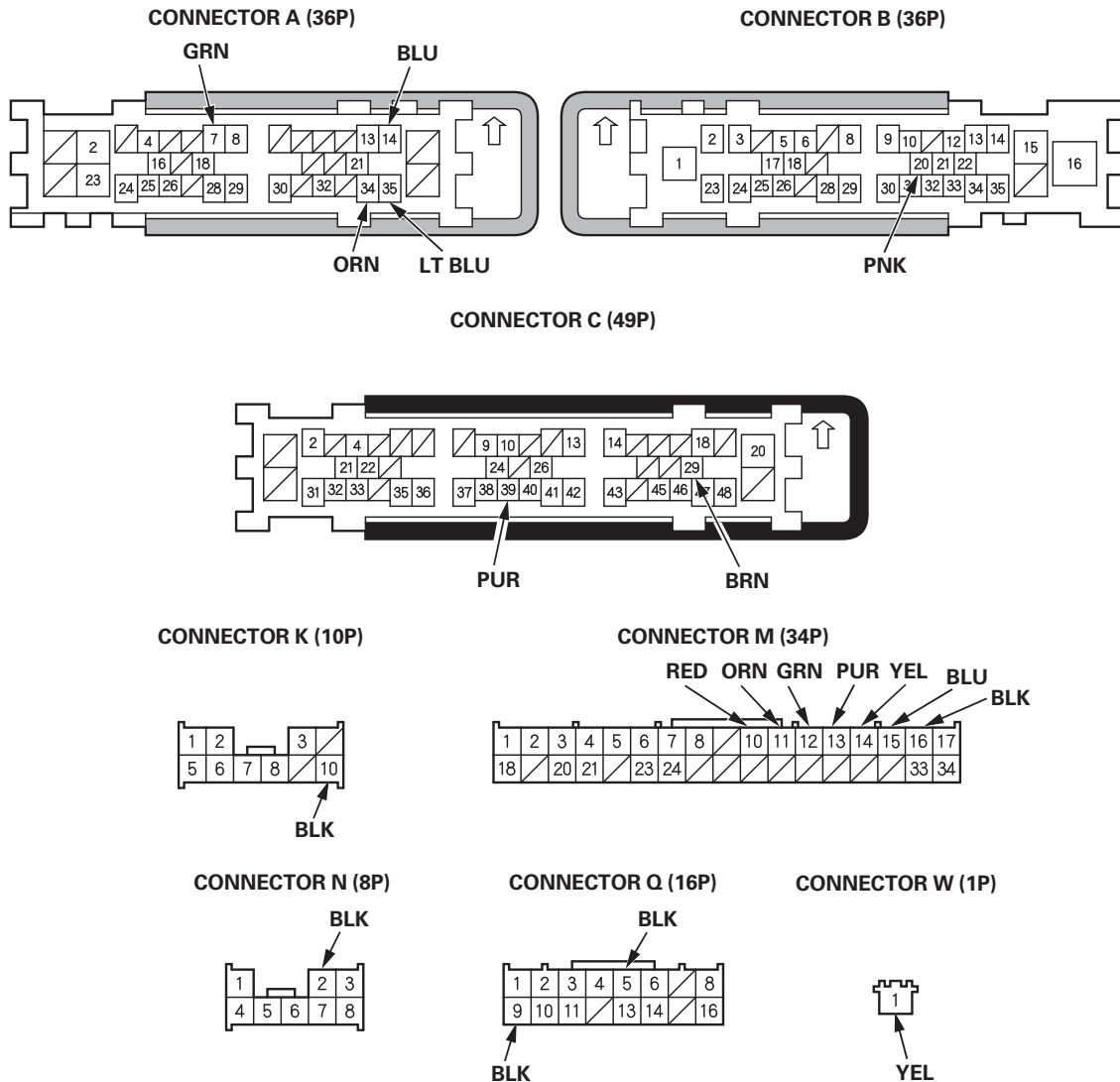

4. Inspect the connector and socket terminals to be sure they are all making good contact.
 - If the terminals are bent, loose or corroded, repair them as necessary and recheck the system.
 - If the terminals look OK, go to step 5.



5. With the connectors still disconnected, do these input tests at the following connectors.

- If any test indicates a problem, find and correct the cause, then recheck the system.
- If all the input tests prove OK, go to step 6.

Cavity	Wire	Test condition	Test: Desired result	Possible cause if desired result is not obtained
W1	YEL	Ignition switch ON (II)	Measure the voltage to ground: There should be battery voltage.	<ul style="list-style-type: none"> • Blown No. 60 (IGN) (50 A) fuse in the under-dash fuse/relay box • Faulty ignition switch • An open or high resistance in the wire
A7	GRN	Under all conditions	Connect the terminal A7 to battery power: The wiper motor should run at high speed.	<ul style="list-style-type: none"> • Poor ground (G301) or an open in the ground wire • Faulty wiper motor • An open or high resistance in the wire
A14	BLU	Under all conditions	Connect the terminal A14 to battery power: The wiper motor should run at low speed.	
A34	ORN	Under all conditions	Connect the terminal A34 to battery power and terminal A35 to body ground: The washer motor should run.	<ul style="list-style-type: none"> • Faulty washer motor • An open or high resistance in the wire
A35	LT BLU	Under all conditions	Connect the terminal A35 to battery power and terminal A34 to body ground: The washer motor should run.	<ul style="list-style-type: none"> • Faulty washer motor • An open or high resistance in the wire
B20	PNK	The motor stops at auto-stop position.	Check for continuity to ground: There should be continuity.	<ul style="list-style-type: none"> • Faulty wiper motor • Poor ground (G301) or an open in the ground wire • An open or high resistance in the wire
		Connect the terminal A14 to the battery power momentarily, and stop the motor operation before the motor reaches the auto-stop position.	Check for continuity to ground: There should be no continuity.	
C39 C29	PUR BRN	Connect battery power to terminal C39, then connect terminal C29 to body ground momentarily.	Check rear window wiper motor operation: The rear window wiper motor should run, and the park position.	<ul style="list-style-type: none"> • Faulty rear window wiper motor • An open or high resistance in the wire • Poor ground (G602) or an open in the ground wire

(cont'd)

Wipers/Washers

MICU Input Test (cont'd)

6. Reconnect the connectors to the under-dash fuse/relay box, turn the ignition switch to ON (II), and do these input tests at the following connectors.

- If any test indicates a problem, find and correct the cause, then recheck the system.
- If all the input tests prove OK, the MICU must be faulty; replace the under-dash fuse/relay box (see page 22-63).

Cavity	Wire	Test condition	Test: Desired result	Possible cause if desired result is not obtained
K10	BLK	In all ignition switch positions	Measure the voltage to ground: There should be less than 0.2 V.	<ul style="list-style-type: none"> • Poor ground (G502) or an open in the ground wire • An open or high resistance in the wire
M16	BLK	In all ignition switch positions	Measure the voltage to ground: There should be less than 0.2 V.	<ul style="list-style-type: none"> • Poor ground (G501) or an open in the ground wire • An open or high resistance in the wire
N2	BLK	In all ignition switch positions	Measure the voltage to ground: There should be less than 0.2 V.	<ul style="list-style-type: none"> • Poor ground (G501) or an open in the ground wire • An open or high resistance in the wire
Q9	BLK	In all ignition switch positions	Measure the voltage to ground: There should be less than 0.2 V.	<ul style="list-style-type: none"> • Poor ground (G502) or an open in the ground wire • An open or high resistance in the wire
M10 · Q5	RED · BLK	Wiper/washer switch (LO or HI) ON	Measure the voltage between terminals M10 and Q5: There should be less than 0.2 V.	<ul style="list-style-type: none"> • Faulty wiper/washer switch • An open or high resistance in the wire
		Wiper/washer switch OFF	Measure the voltage between terminals M10 and Q5: There should be about 5 V or more.	Faulty wiper/washer switch
M11 · Q5	ORN · BLK	Wiper/washer switch (INT or LO) ON	Measure the voltage between terminals M11 and Q5: There should be less than 0.2 V.	<ul style="list-style-type: none"> • Faulty wiper/washer switch • An open or high resistance in the wire
		Wiper/washer switch OFF	Measure the voltage between terminals M11 and Q5: There should be about 5 V or more.	Faulty wiper/washer switch
M12 · Q5	GRN · BLK	Wiper/washer switch (MIST) ON	Measure the voltage between terminals M12 and Q5: There should be less than 0.2 V.	<ul style="list-style-type: none"> • Faulty wiper/washer switch • An open or high resistance in the wire
		Wiper/washer switch OFF	Measure the voltage between terminals M12 and Q5: There should be about 5 V or more.	Faulty wiper/washer switch
M13 · Q5	PUR · BLK	Washer switch ON	Measure the voltage between terminals M13 and Q5: There should be less than 0.2 V.	<ul style="list-style-type: none"> • Faulty wiper/washer switch • An open or high resistance in the wire
		Washer switch OFF	Measure the voltage between terminals M13 and Q5: There should be about 5 V or more.	Faulty wiper/washer switch
M14 · Q5	YEL · BLK	Rear window wiper/washer switch (RR WIPER) ON	Measure the voltage between terminals M14 and Q5: There should be less than 0.2 V.	<ul style="list-style-type: none"> • Faulty Rear window wiper/washer switch • An open or high resistance in the wire
		Rear window wiper/washer switch OFF	Measure the voltage between terminals M14 and Q5: There should be about 5 V or more.	Faulty Rear window wiper/washer switch



Cavity	Wire	Test condition	Test: Desired result	Possible cause if desired result is not obtained
M15 · Q5	BLU · BLK	Rear window wiper/washer switch (RR WASH) ON	Measure the voltage between terminals M15 and Q5: There should be less than 0.2 V.	<ul style="list-style-type: none">• Faulty Rear window wiper/washer switch• An open or high resistance in the wire
		Rear window wiper/washer switch OFF	Measure the voltage between terminals M15 and Q5: There should be about 5 V or more.	Faulty Rear window wiper/washer switch

Wipers/Washers

Wiper/Washer Switch Test/Replacement

1. Remove the steering column covers (see page 20-100).
2. Disconnect the dashboard wire harness 8P connector (A) from the wiper/washer switch (B).
3. Turn the steering wheel to access the wiper/washer switch screws (C).

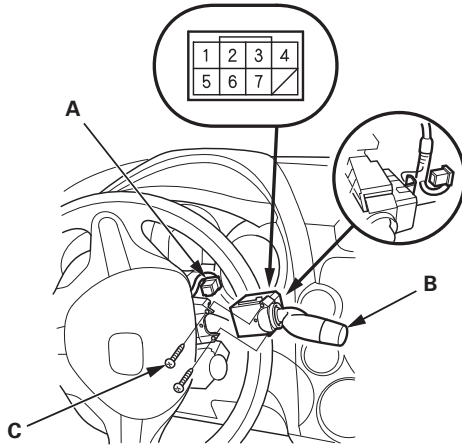

4. Remove the two screws, then slide out the wiper/washer switch.
5. Inspect the connector terminals to be sure they are all making good contact.
 - If the terminals are bent, loose or corroded, repair them as necessary, and recheck the system.
 - If the terminals look OK, go to step 5.

6. Check for continuity between the terminals in each switch position according to the table.

Wiper

Terminal Position	1	2	3	4	5
OFF					
INT		○	—		○
LO		○	—	○	○
HI				○	○
Mist ON			○	—	○
Washer ON	○	—			○

Rear window wiper

Terminal Position	7	6	5
Washer Switch ON, wiper switch OFF		○	○
OFF			
Wiper switch ON, washer switch OFF	○	—	○
Wiper and washer switch ON	○	—	○

7. If the continuity is not as specified, replace the switch.
8. Install the switch in the reverse order of removal.

Wiper Motor Test

Windshield

1. Remove the wiper arms (see page 22-231) and the cowl lid (A).

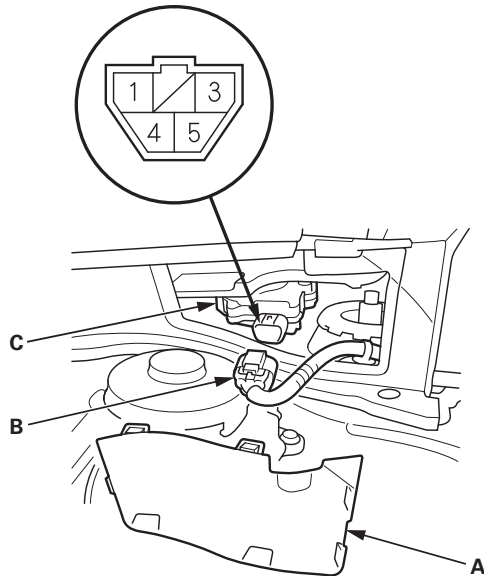

2. Disconnect the 5P connector (B) from the wiper motor (C).
3. Test the motor by connecting battery power to terminal No. 3 and ground to terminal No. 4 of the wiper motor 5P connector. The motor should run at low speed.
4. Test the motor by connecting battery power to terminal No. 5 and ground to terminal No. 4 of the wiper motor 5P connector. The motor should run at high speed.
5. Connect an analog ohmmeter to terminals No. 1 and No. 4, and run the motor at low speed (repeat step 3). The needle of the ohmmeter should pulse.
6. If the motor does not run, or fails to run smoothly, or there is no pulse, replace the motor.

Rear Window

NOTE: If there is malfunction of the rear window wiper operation, and no DTCs are detected, test the rear window wiper motor as described below, and check for an open or high resistance in the ground circuit of the rear window wiper (see step 9 on page 22-216).

1. Open the tailgate, and remove the tailgate lower trim panel (see page 20-76).
2. Disconnect the 4P connector (A) from the wiper motor (B).

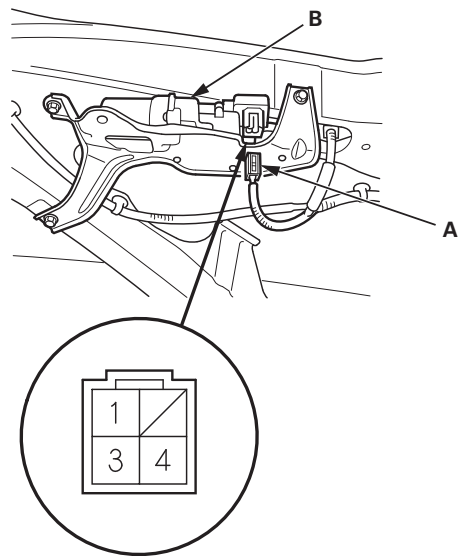

3. Test the motor by connecting battery power to terminal No. 1 and ground to terminal No. 3 of the wiper motor. The motor should run.
4. Connect an analog ohmmeter between rear window wiper motor 4P connector terminals No. 3 and No. 4 and run the motor (repeat step 3). The needle of the ohmmeter should pulse.
5. If the motor does not run, or fails to run smoothly, or there is no pulse, replace the motor.

Wipers/Washers

Washer Motor Test

1. Remove the right inner fender (see page 20-170).
2. Disconnect the 2P connector (A) from the washer motor (B).

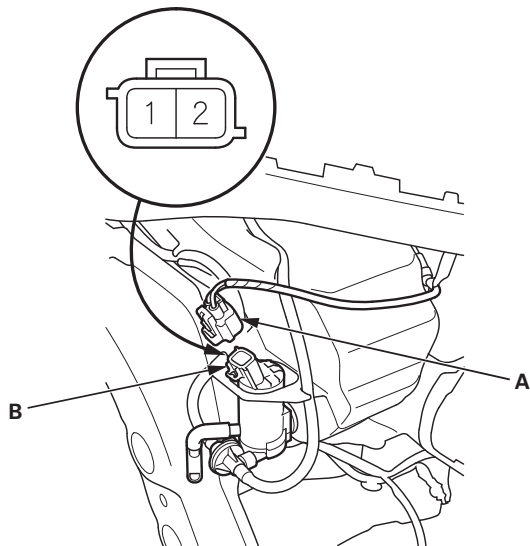

3. Test the motor by connecting battery power to terminal No. 1 (or No. 2), and ground to terminal No. 2 (or No. 1) of the washer motor. The motor should run.
 - If the motor does not run, or fails to run smoothly, replace it.
 - If the motor runs smoothly, but little or no washer fluid is pumped, check for a disconnected or blocked washer hose, or a clogged washer motor outlet.

Washer Fluid Level Switch Test

Canada models

1. Remove the right inner fender (see page 20-170).
2. Disconnect the 2P connector (A) from the washer fluid level switch (B).

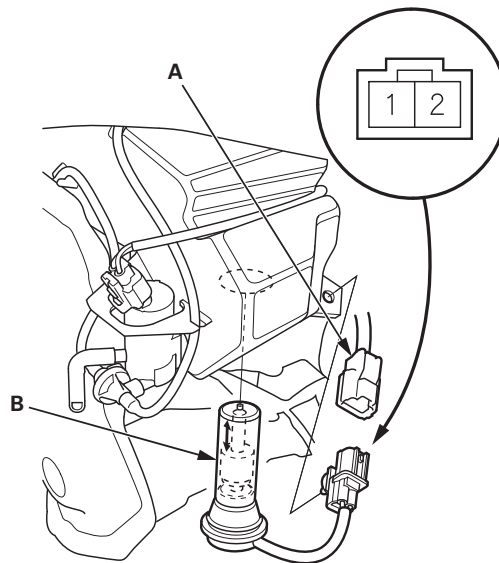

3. Remove the washer fluid level switch from the washer reservoir.

NOTE: Fluid may flow out of the opening.

4. Check for continuity between terminals No. 1 and No. 2 in each float position.
 - There should be continuity when the float is down.
 - There should be no continuity when the float is up.
5. If the continuity is not as specified, replace the switch.

Wiper Motor Replacement

Windshield

NOTE: Be careful not to scratch or damage the hood and the body.

1. Remove the wiper arms (see page 22-231).
2. Remove the cowl cover (see page 20-161).
3. Disconnect the 5P connector (A) from the wiper motor (B).

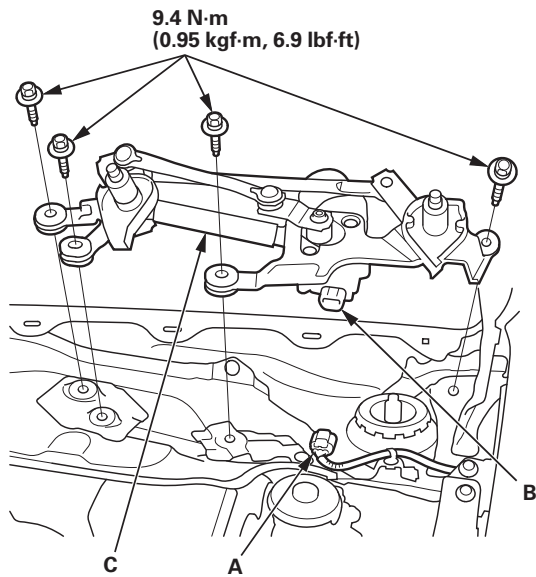

4. Remove the bolts and the wiper linkage assembly (C).

5. Mark lines (A) to show the original adjustment, then remove the connection rod (B) from the linkage (C).

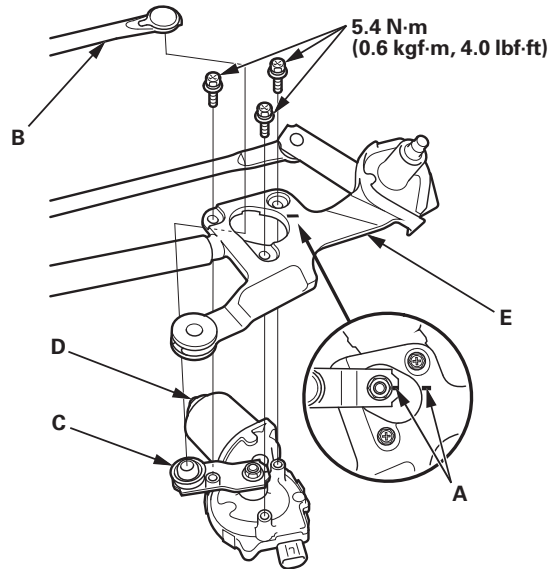

6. Remove the three bolts and separate the wiper motor (D) from the linkage assembly (E) through the hole.

(cont'd)

Wipers/Washers

Wiper Motor Replacement (cont'd)

Installation

1. Before installing the motor, connect the 5P connector to the wiper motor, and turn the wiper/washer switch ON to LO or HI position, then OFF to return the motor shaft to the park position.

NOTE:

- Do not use the wiper/washer switch INT position in this step.
 - Apply multipurpose grease to the moving parts.
2. Install the wiper motor to the wiper linkage assembly in the reverse order of removal.
 3. Install the linkage to the wiper motor shaft, then align the mark (A) of the linkage and the mark (B) of the wiper linkage assembly.

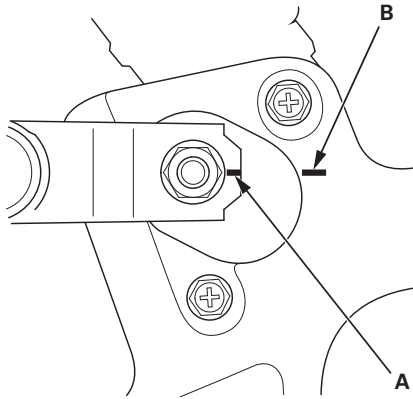

4. After installation, adjust the wiper arms (see page 22-234).

Rear Window

NOTE: Be careful not to scratch or damage the tailgate.

1. Remove the rear window wiper arm (see page 22-231).
2. Open the tailgate, and remove the tailgate lower trim panel (see page 20-76).
3. Disconnect the 4P connector (A) from the rear window wiper motor (B).

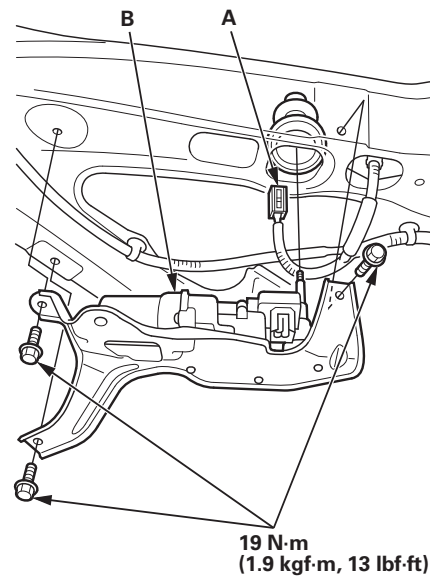

4. Remove the three bolts and the rear window wiper motor.
5. Install in the reverse order of removal, and note these items:
 - Grease the moving parts.
 - Before reinstalling the wiper arm, turn the rear window wiper switch ON, then OFF to return the wiper shaft to the park position.
 - Check the wiper motor operation.

Wiper Arm Replacement

NOTE: Set the wiper arms to the auto-stop position before removal and installation.

Windshield

NOTE: Always pull up the driver's side wiper blade first.

1. Remove the caps, the nuts, and the wiper arms.

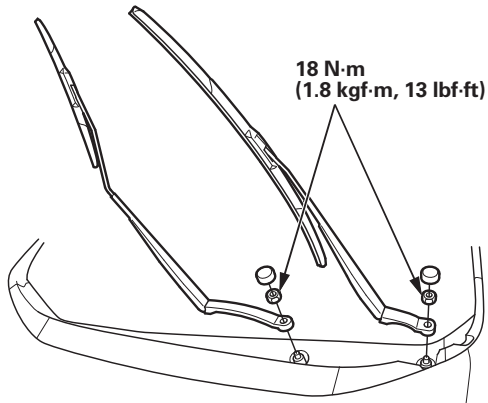

Rear Window

NOTE: Be careful not to damage the tailgate.

1. Remove the cover, the nut, and the wiper arm.

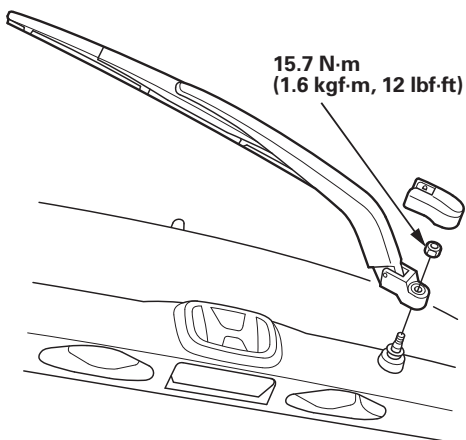

Washer Reservoir Replacement

1. Remove the front bumper (see page 20-138).
2. Disconnect the 2P connector (A) and tubes (B) from the washer motor (C) and the washer fluid level switch (Canada models).

Washer Reservoir Capacity:

2.5 L (2.64 US qt): USA models

4.5 L (4.75 US qt): Canada models

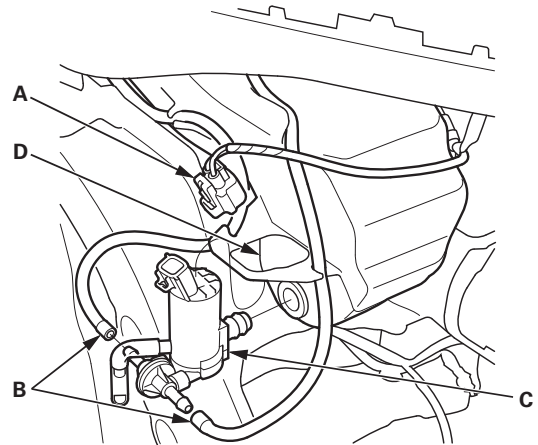

3. Remove the washer motor from the washer reservoir (D).
4. Remove the bolts (A) and clips (B), then remove the washer reservoir (C).

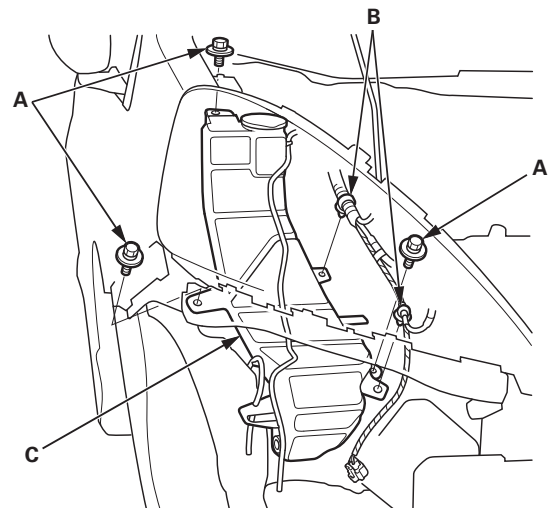

5. Install the washer reservoir in the reverse order of removal. Check the washer motor operation.

Wipers/Washers

Wiper Blade Replacement

Windshield

NOTE: Always pull up the driver's side wiper blade first.

1. Pull up and hold the tab (A) of the wiper blade assembly (B), and remove the wiper blade assembly from the wiper arm (C).

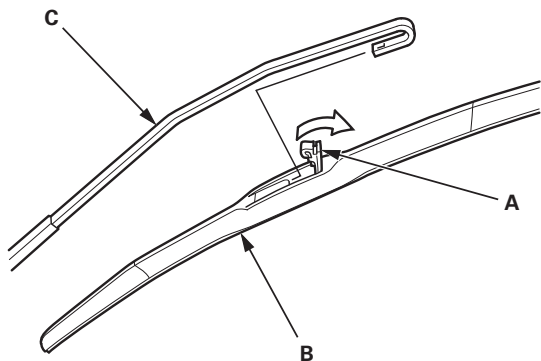

2. Slide the wiper blade (A) out of the wiper blade holder (B).

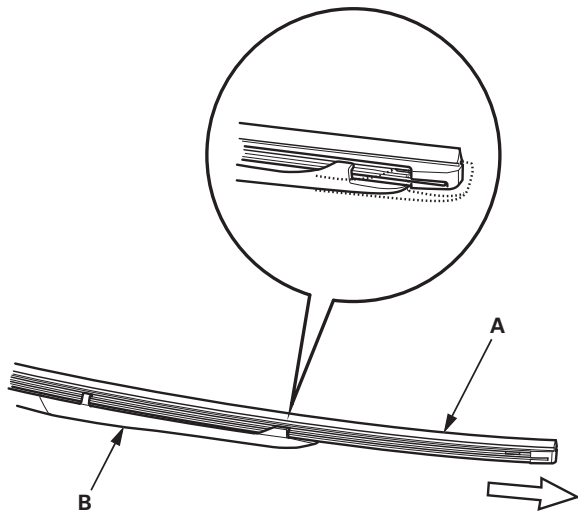

3. Align the groove (A) in each rail (B) with the tabs in a new wiper blade, then install the new wiper blade and rails into the blade holder in the reverse order of removal.

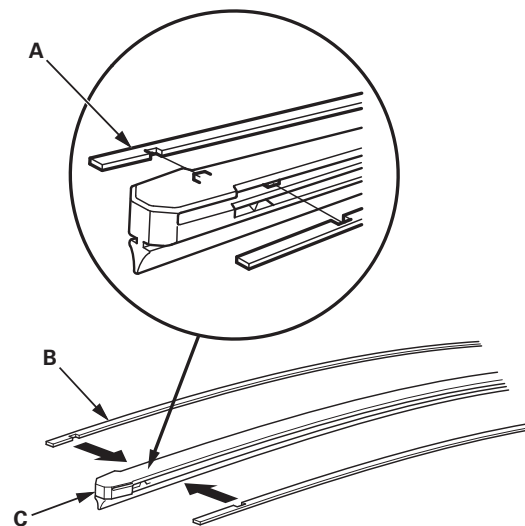

4. Install the wiper blade assemblies onto the wiper arms in the reverse order of removal.
5. Test the wiper operation. If the blades slip, turn the wiper switch OFF, and reinstall the blades securely.

Rear Window

1. Turn the wiper blade assemblies (A), and remove the lock from the wiper arm (B).

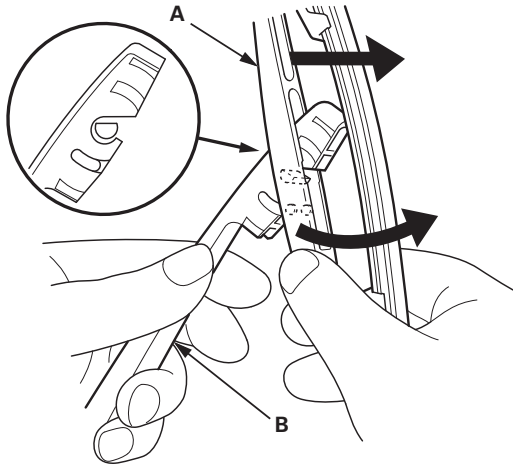

2. Pull the wiper blade (A) up, and slide it out from the wiper blade holder (B).

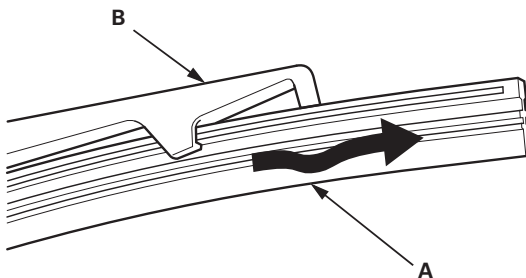

3. Install a new wiper blade in the reverse order of removal.
4. Install the wiper blade onto the wiper arm in the reverse order of removal.
5. Test the wiper operation. If the blade slips, turn the wiper switch OFF, and reinstall the blade securely.

Wipers/Washers

Wiper Arm/Nozzle Adjustment

Wiper arms stop position

1. When the wiper arms stop at the automatic stop position, make sure that they are at the correct position.

Windshield

- a: Position at about 92 mm (3.6 in) from the top of cowl cover (A).
- b: Position at about 36 mm (1.4 in) from the top of cowl cover (A).

Rear window

- c: Position at about 10 mm (0.4 in) from the black ceramic area (D).

Washer nozzle position

2. When you turn on the washers, make sure 50 % or more of the washer fluid lands within the spray area. If the spray area is not within the standard positions, adjust the nozzles.

Windshield

- d: Position at about 601 mm (24 in) from the top of the black ceramic area (B) at the lower windshield.
- e: Position at about 485 mm (19 in) from the top of the black ceramic area (B) at the lower windshield.
- f: Position at about 601 mm (24 in) from the top of the black ceramic area (B) at the lower windshield.
- g: Position at about 250 mm (9.8 in) from the windshield center line (C).
- h: Position at about 250 mm (9.8 in) from the windshield center line (C).

Rear Window

- j: Position at about 24.7 mm (1.0 in) from the top of the black ceramic area (E).

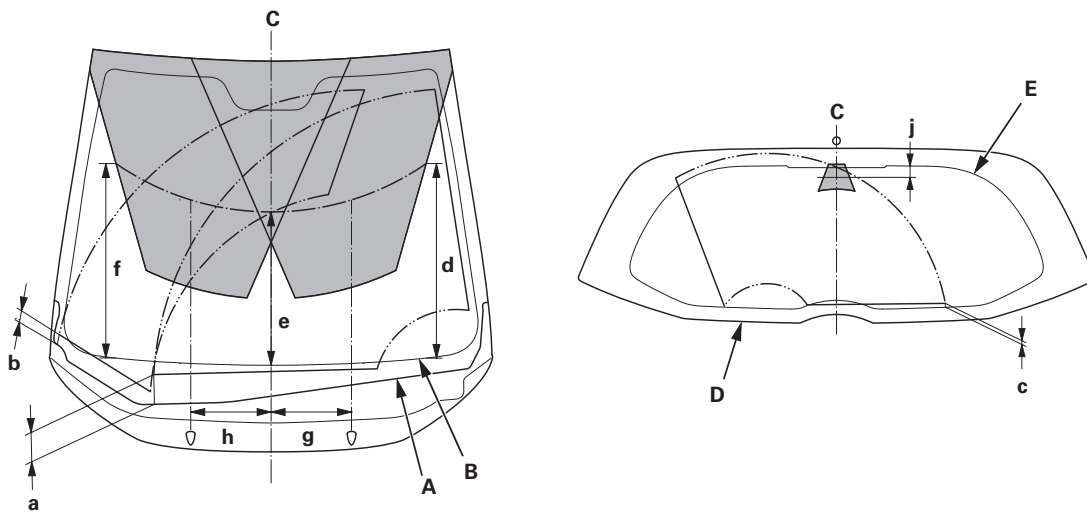

Washer Tube Replacement

- 1. Remove the right inner fender (see page 20-170).
- 2. Remove the washer nozzles and clips, then remove the tubes.

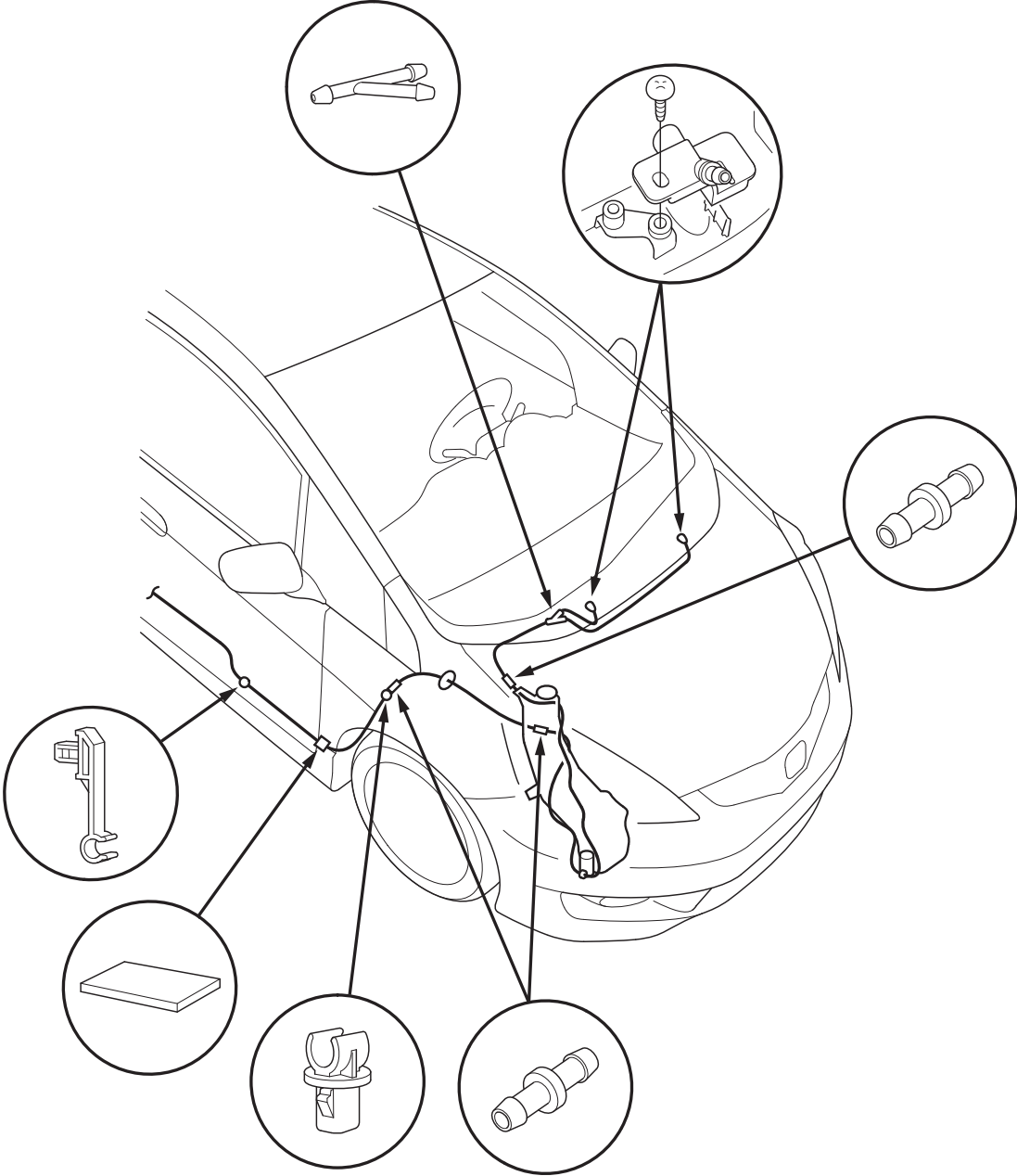

(cont'd)

Wipers/Washers

Washer Tube Replacement (cont'd)

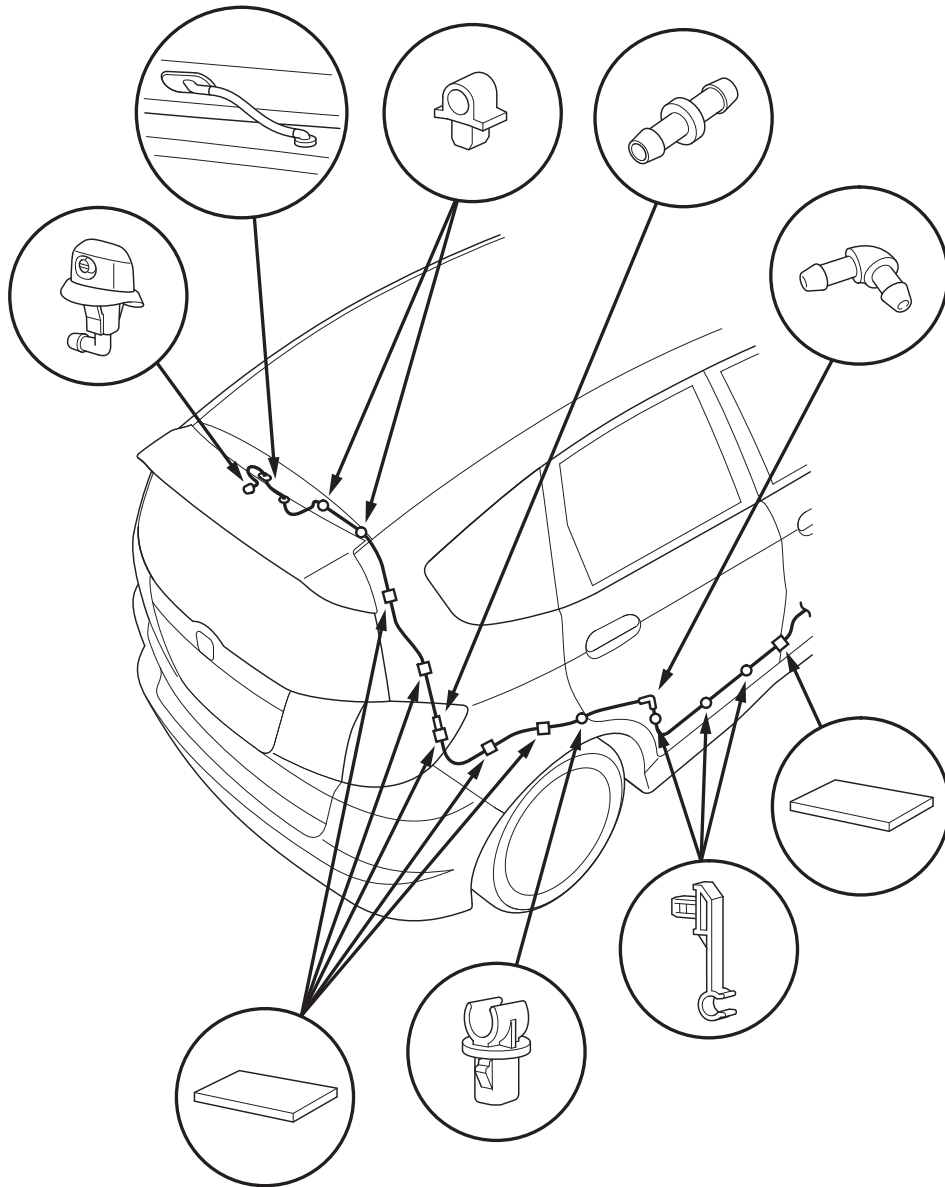

3. Install the parts in the reverse order of removal. Take care not to pinch the washer tubes. Check the washer operation.