

Your Current Vehicle: 2013 Honda Fit

Rate this article: ★ ★ ★ ★ ★

Rear **Trailing** Arm Removal and Installation

NOTE

Applicable vehicles:

- 2013-14 Honda FIT EV

Rear **Trailing** Arm Removal and Installation

Removal

1. Vehicle - Lift
 1. Raise and support the vehicle.
2. Rear Wheel - Remove
 1. Remove the rear wheel.
3. Rear Wheel Speed Sensor, Brake Hose Mounting Bracket, and Brake Line - Remove

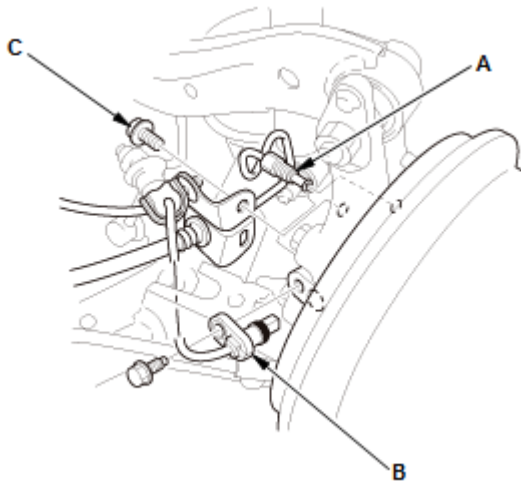

NOTE

Do not spill brake fluid on the vehicle; it may damage the paint. If brake fluid gets on the paint, wash it off immediately with water.

1. Disconnect the brake line (A) from the wheel cylinder.

NOTE: After removal, plug the ends of the hoses and the joints to prevent spilling brake fluid.

2. Remove the wheel speed sensor (B).

NOTE: Do not disconnect the wheel speed sensor connector.

3. Remove the brake hose bracket bolt (C).

4. Parking Brake Cable Bracket Bolt - Remove

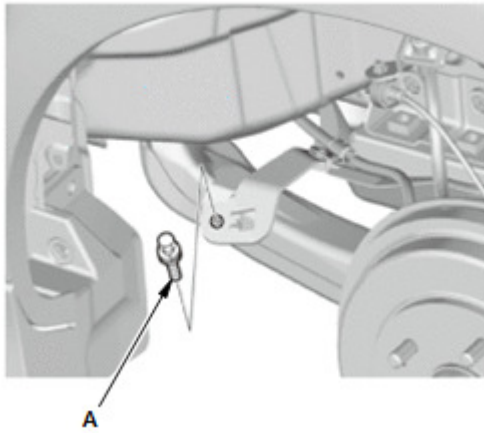

1. Remove the parking brake cable bracket bolt (A).

5. Rear Knuckle - Jack Up

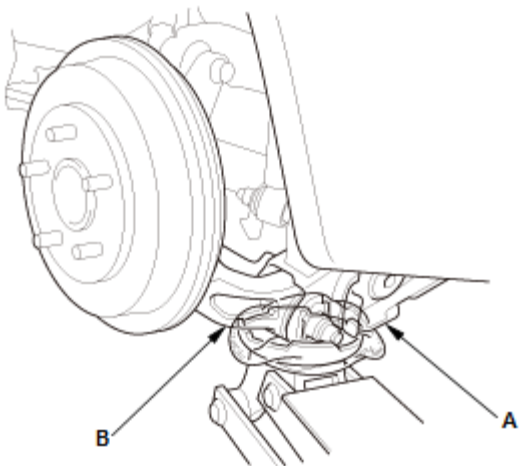

1. Position a floor jack at the connecting point of the **trailing** arm (A) and the knuckle (B).
2. Raise the floor jack until the suspension begins to compress.

6. Rear Damper Lower Side - Disconnect

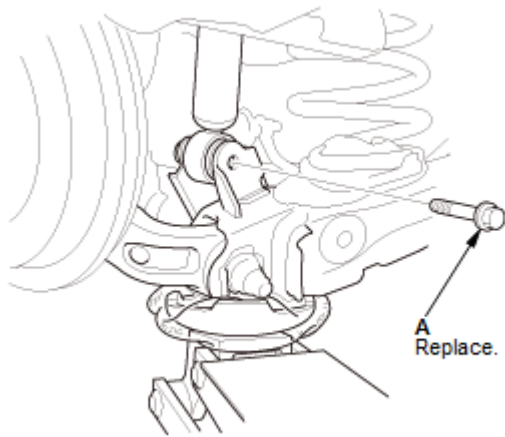

1. Remove the damper mounting bolt (A).

7. Rear Upper Arm Knuckle Side - Disconnect

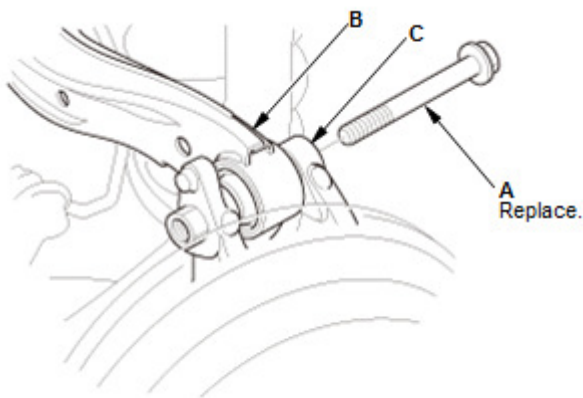

1. Remove the flange bolt (A).

2. Disconnect the upper arm (B) from the knuckle (C).

8. Stabilizer Link - Disconnect

1. Disconnect the stabilizer link from the **trailing** arm.

9. Rear **Trailing** Arm Knuckle Side - Disconnect

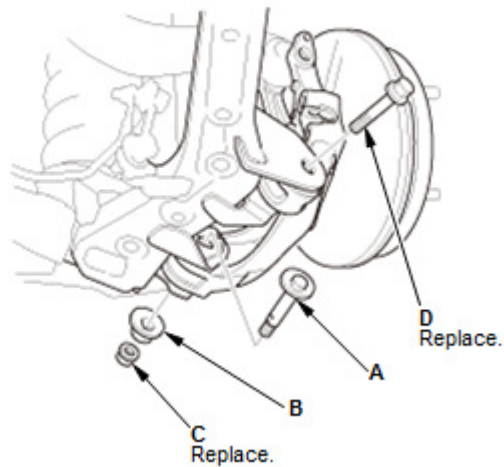

1. Mark the cam positions of the adjusting bolt (A) with the frame.
2. Mark the cam positions of the adjusting cam plate (B) with the frame.
3. Remove the self-locking nut (C), the adjusting cam plate, and the adjusting bolt.
4. Remove the flange bolt (D).
5. Disconnect the knuckle and brake assembly from the **trailing** arm.

10. Rear **Trailing** Arm - Remove

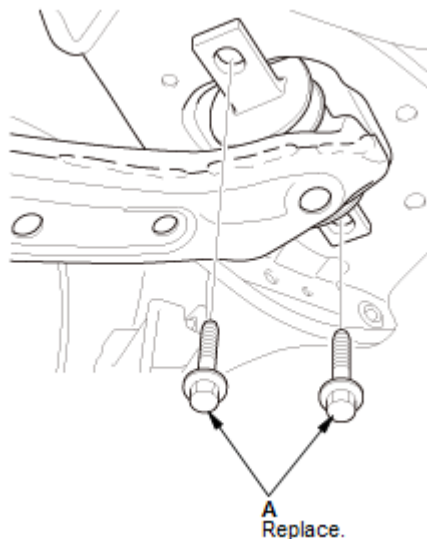

1. Remove the **trailing** arm front mounting bolts (A).
2. Lower the floor jack gradually.

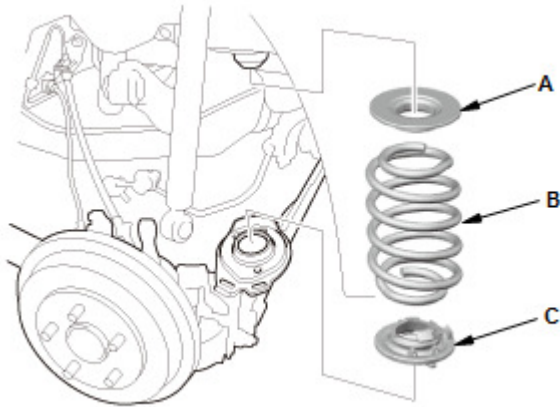

3. Remove the spring mounting rubber (A).
4. Remove the spring (B).
5. Remove the lower spring seat (C).

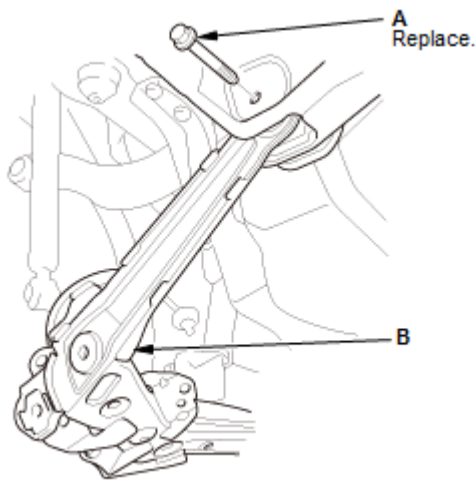

6. Remove the **trailing** arm rear mounting bolt (A).
7. Lower the jack, and remove the **trailing** arm (B).

Feedback

Installation

1. Rear **Trailing** Arm - Install

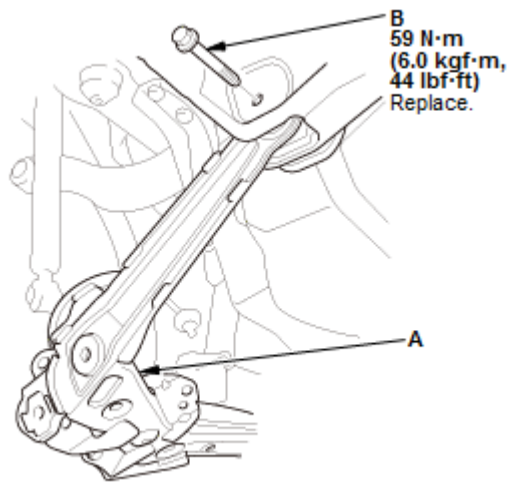

1. Install the **trailing** arm (A).
2. Loosely install the new **trailing** arm rear mounting bolt (B).

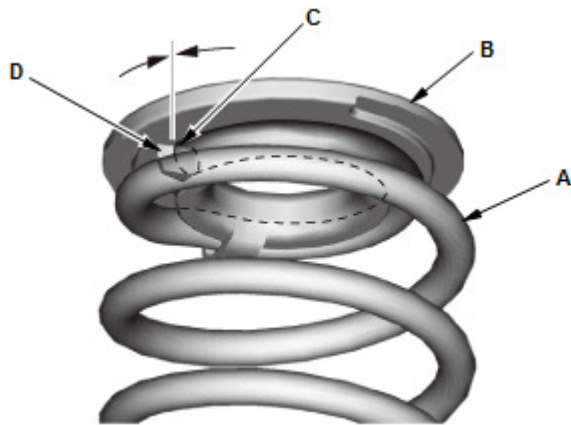

3. Install the spring (A) on the spring mounting rubber (B) by aligning the upper end (C) of the spring with the ledge portion (D) of the spring mounting rubber.

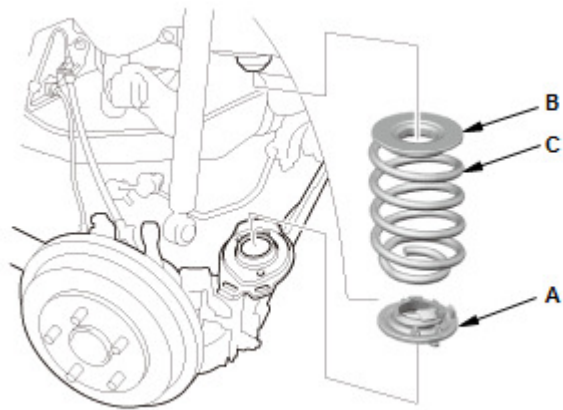

4. Install the lower spring seat (A).
5. Install the spring mounting rubber (B) and the spring (C).

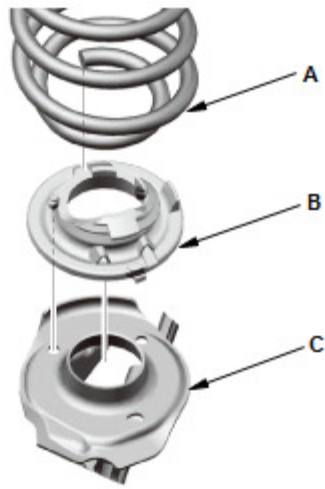

6. Align the bottom of the spring (A) and the lower spring seat (B) with the **trailing** arm (C) as shown.

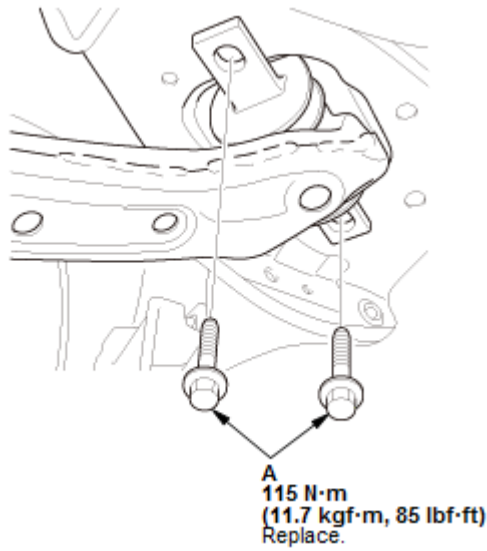

7. Loosely install the new **trailing** arm front mounting bolts (A).

2. Rear **Trailing** Arm Knuckle Side - Reconnect

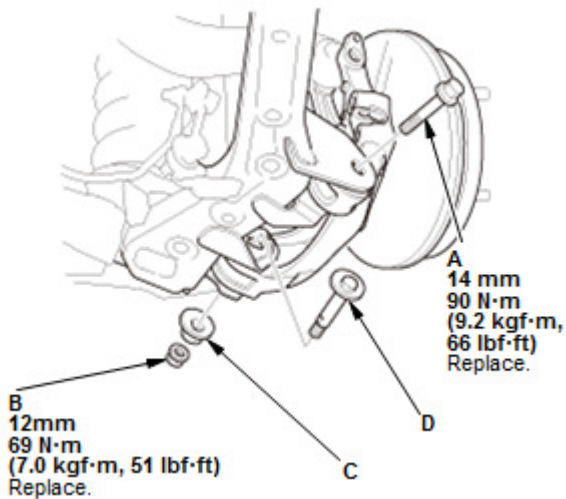

1. Reconnect the knuckle and brake assembly to the **trailing** arm.
2. Loosely install the new flange bolt (A).
3. Loosely install the new self-locking nut (B), the adjusting cam plate (C), and the new adjusting bolt (D).

NOTE: Align the cam positions of the

adjusting bolt and the adjusting cam plate with the marked positions when tightening the self-locking nut.

3. Stabilizer Link - Reconnect

1. Reconnect the stabilizer link to the **trailing** arm.

4. Rear Upper Arm Knuckle Side - Reconnect

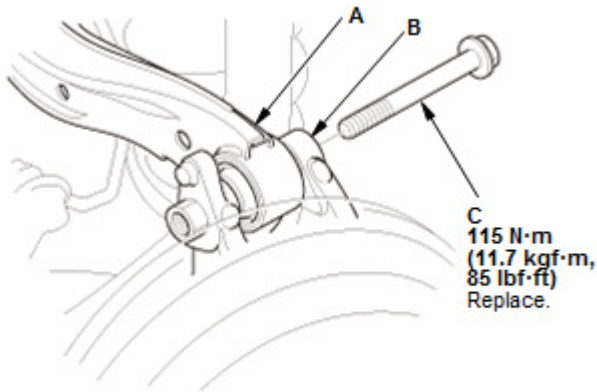

1. Reconnect the upper arm (A) to the knuckle (B).
2. Loosely install the new flange bolt (C).

5. Rear Damper Lower Side - Reconnect

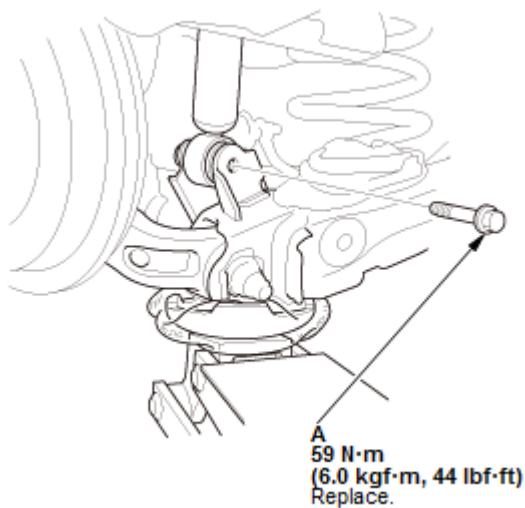

1. Loosely install the new damper mounting bolt (A).

6. Bolt and Nut - Tighten Under Vehicle's Weight

1. Load the suspension with the vehicle's weight.
2. Tighten all loosely installed mounting hardware to the specified torque.

7. Jack - Release

1. Release the jack.

8. Parking Brake Cable Bracket Bolt - Install

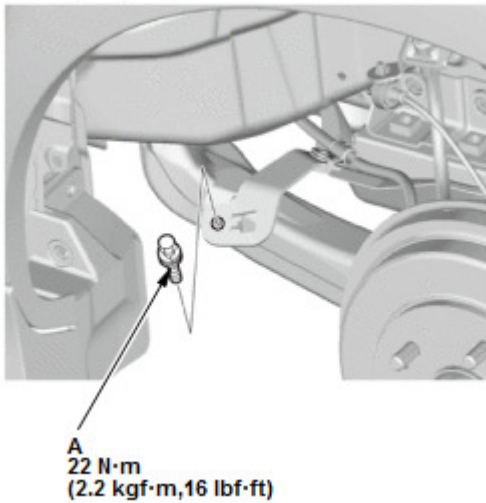

1. Install the parking brake cable bracket bolt (A).

9. Rear Wheel Speed Sensor, Brake Hose Mounting Bracket, and Brake Line - Install

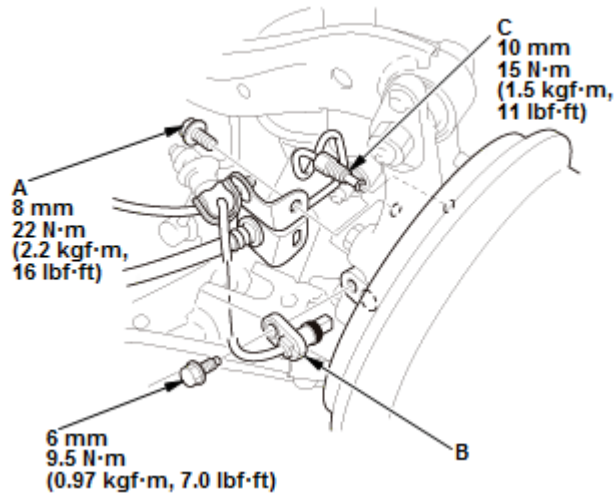

1. Install the brake hose bracket bolt (A).
2. Install the wheel speed sensor (B).
3. Reconnect the brake line (C) to the wheel cylinder.

10. Brake System - Bleeding

1. Bleed the brake system.

11. Rear Wheel - Install

1. Install the rear wheel.

12. Wheel Alignment - Check

1. Check the wheel alignment, and adjust it if necessary.

[\(/lh/Home/Index/mwellg2e-wOgc1AZurtESjV5SYVDI6oO9vjunnBff9lrso1\)Home](#)

[Terms and Conditions \(//www.cengage.com/content/footer/terms_of_use.aspx\)](#)

[Privacy Statement \(//www.cengage.com/content/footer/privacy_statement.aspx\)](#)

[Contact Us \(//www.cengage.com/contact/\)](#)

