

Intake Manifold and Exhaust System

Intake Manifold/Chamber Assembly Removal and Installation

Exploded View

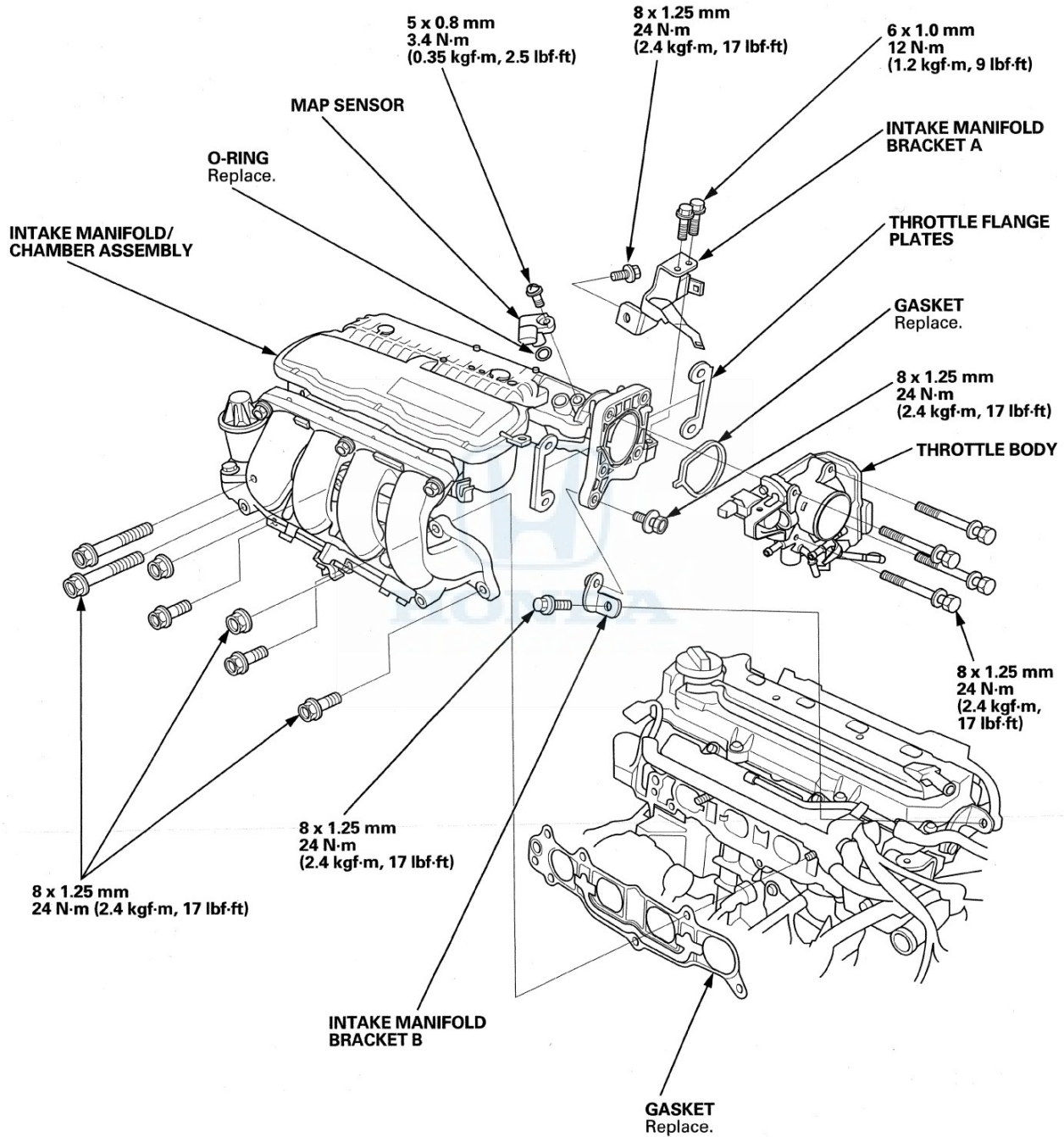

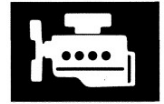

Removal

1. Remove the under-cowl panel (see page 20-185).
2. Remove the air cleaner (see page 11-307).
3. Disconnect the engine wire harness connectors, and remove the wire harness clamps from the intake manifold chamber:
 - Throttle actuator connector
 - MAP sensor connector
 - EGR valve connector
4. Disconnect the brake booster vacuum hose (A) and remove the harness clamp (B).

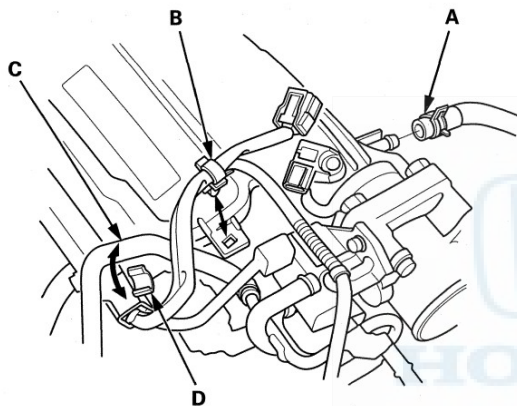

5. Remove the water bypass hose (C) from the clamp (D).
6. Remove the throttle body (A) without disconnecting the water bypass hoses.

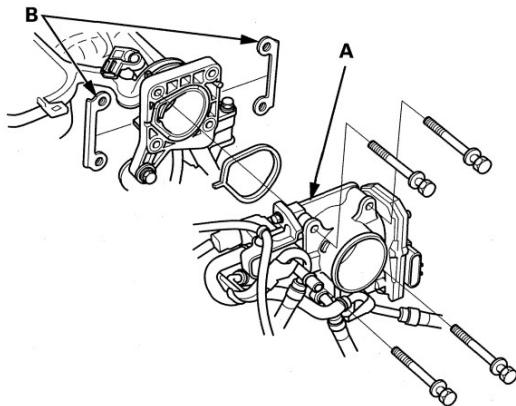

7. Remove the throttle flange plates (B).

8. Remove the harness holder (A) and the dipstick (B).

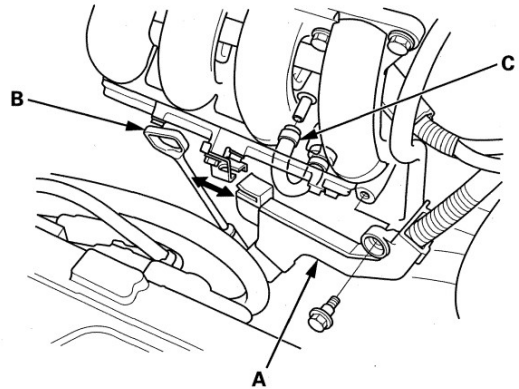

9. Disconnect the PCV hose (C).
10. Remove the intake manifold bracket mounting bolts.

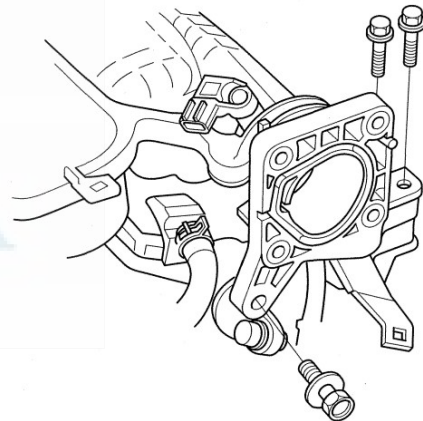

(cont'd)

Intake Manifold and Exhaust System

Intake Manifold/Chamber Assembly Removal and Installation (cont'd)

11. Remove the intake manifold/chamber assembly (A) from the cylinder head.

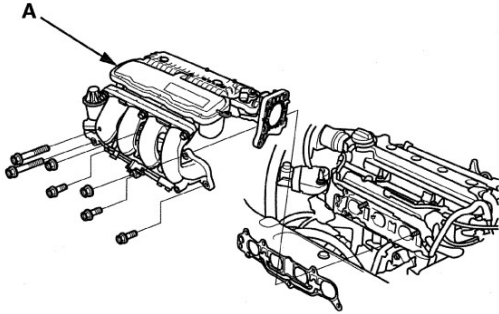

12. Disassemble the intake manifold/chamber assembly.
NOTE: Refer to the Exploded View if needed during this procedure.

Installation

1. Reassemble the intake manifold/chamber assembly.
NOTE: Refer to the Exploded View if needed during this procedure.
2. Install the intake manifold/chamber assembly (A) with a new gasket (B).
NOTE: Tighten the bolts and nuts in a crisscross pattern in three steps, beginning with the inner bolt.

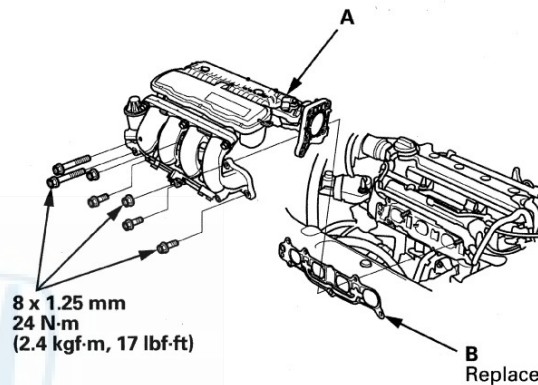

3. Loosen the intake manifold bracket mounting bolts (A, B), then loosely install the intake manifold bracket mounting bolts (C, D).

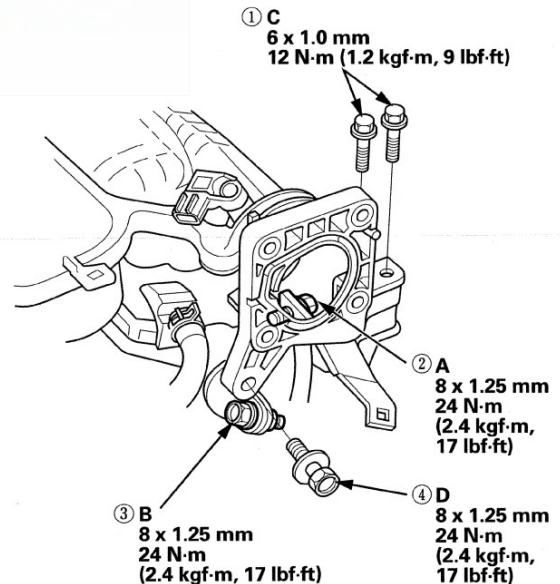

4. Tighten the intake manifold bracket mounting bolts in the numbered sequence shown.



5. Install the throttle body (A) with a new gasket (B), and the throttle flange plates (C).

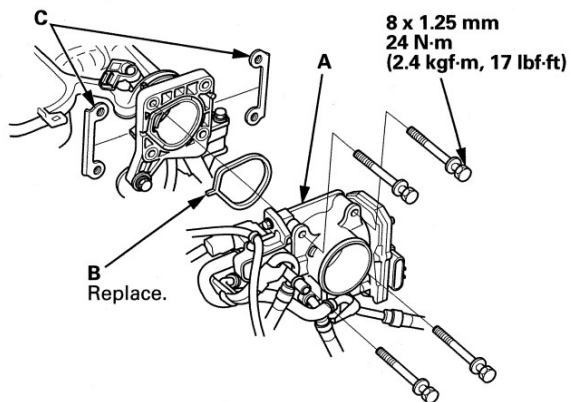

6. Connect the PCV hose (A).

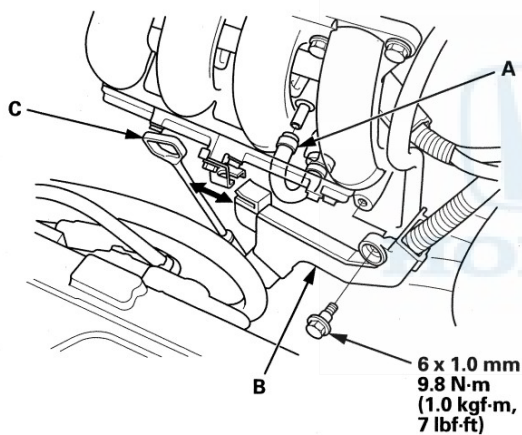

7. Install the harness holder (B) and the dipstick (C).

8. Install the water bypass hose (A) to the clamp (B).

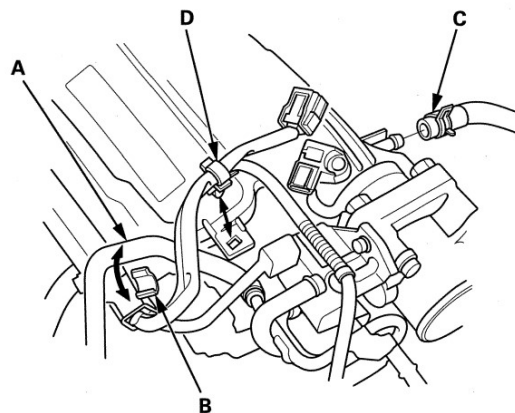

9. Connect the brake booster vacuum hose (C) and install the harness clamp (D).

10. Connect the engine wire harness connectors, and install the wire harness clamps to the intake manifold chamber:

- Throttle actuator connector
- MAP sensor connector
- EGR valve connector

11. Install the air cleaner (see page 11-307).

12. Install the under-cowl panel (see page 20-185).