

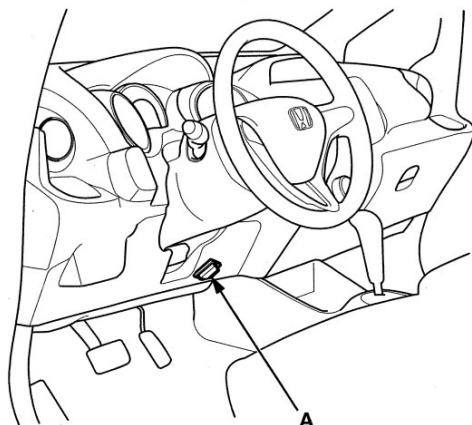

Air Cleaner Removal/Installation

6. Connect the HDS to the data link connector (DLC) (A) located under the driver's side of the dashboard.



7. Turn the ignition switch to ON (II).
8. Reset the ECM/PCM with the HDS.
9. Select the ETCS TEST in the INSPECTION MENU with the HDS.
10. Select the TP POSITION CHECK, then clear the throttle position (TP) learned value.
11. Turn the ignition switch to LOCK (0).
12. Turn the ignition switch to ON (II), and wait 2 seconds without pressing the accelerator pedal.
13. Do the ECM/PCM idle learn procedure (see page 11-268).

1. Disconnect the MAF sensor/IAT sensor connector (A), then remove the air cleaner cover (B) and the air cleaner element (C).

NOTE: Be careful not to damage the MAF sensor/IAT sensor on the air cleaner cover.

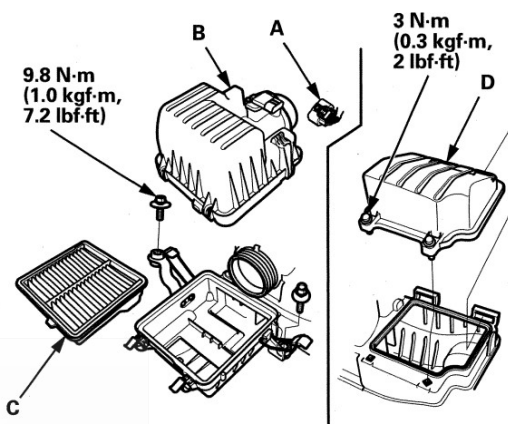

2. Remove the air cleaner chamber (D).
3. Apply protective tape to the air cleaner, the cowl cover, and the battery terminal fuse box (A) as shown.

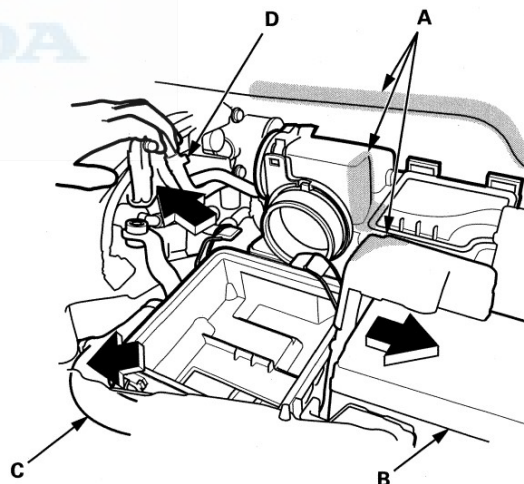

4. Remove the battery hold down, and reposition the battery (B). Reposition the radiator upper hose (C), and the breather pipe (D) as shown.

NOTE: Do not disconnect the battery terminals.

(cont'd)

Intake Air System

Air Cleaner Removal/Installation (cont'd)

5. Apply protective tape to the air cleaner (A) as shown.

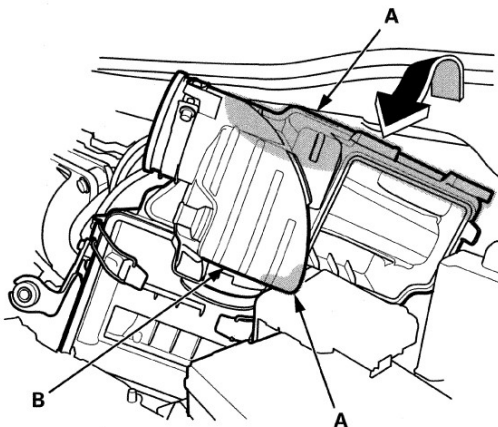

6. Turn the air cleaner (B) case as shown.

7. Remove the air cleaner case (A) as shown.

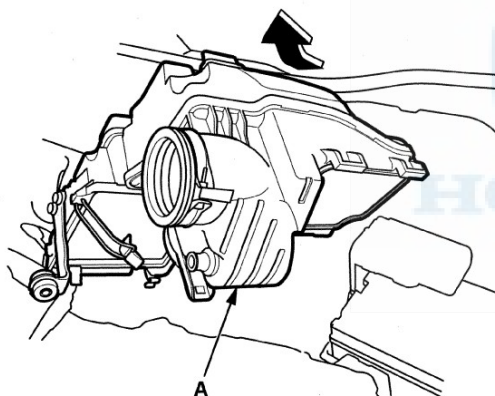

8. Install the parts in the reverse order of removal.

Air Cleaner Element Inspection/Replacement

1. Open the air cleaner housing cover (A).

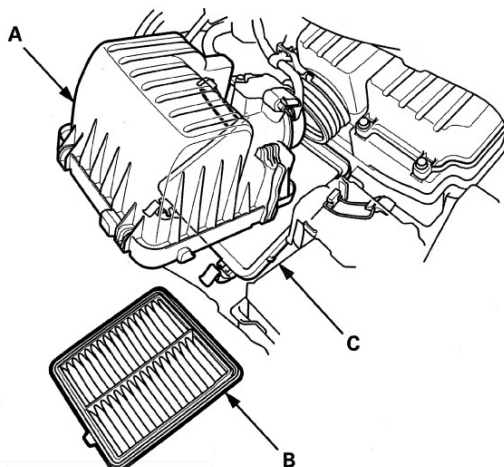

2. Remove the air cleaner element (B) from the air cleaner housing (C).

3. Check the air cleaner element for damage, dirt, or clogging. If it is damaged or clogged, replace it.

NOTE: Do not use compressed air to clean the air cleaner element.

4. Clean and remove any debris from inside the air cleaner housing.

5. Install the parts in the reverse order of removal:

- If you did not replace the air cleaner element, this procedure is complete.
- If the maintenance minder required air cleaner element replacement, reset the maintenance minder (see page 3-6).
- If the idle speed fluctuates, do the idle speed inspection (see page 11-267).



Throttle Body Removal/Installation

CAUTION

Do not insert your fingers into the installed throttle body when you turn the ignition switch to ON (II) or while the ignition switch is in ON (II). If you do, you will seriously injure your fingers if the throttle valve is activated.

NOTE: If you are replacing or cleaning the throttle body, start at step 1. If you are removing the throttle body temporarily, begin at step 4.

1. Connect the HDS to the DLC while the engine is stopped.
2. Select the INSPECTION MENU on the HDS.
3. Do the TP POSITION CHECK in the ETCS TEST.
4. Turn the ignition switch to LOCK (0).
5. Remove the air cleaner (see page 11-307).
6. Remove the harness clamp (A).

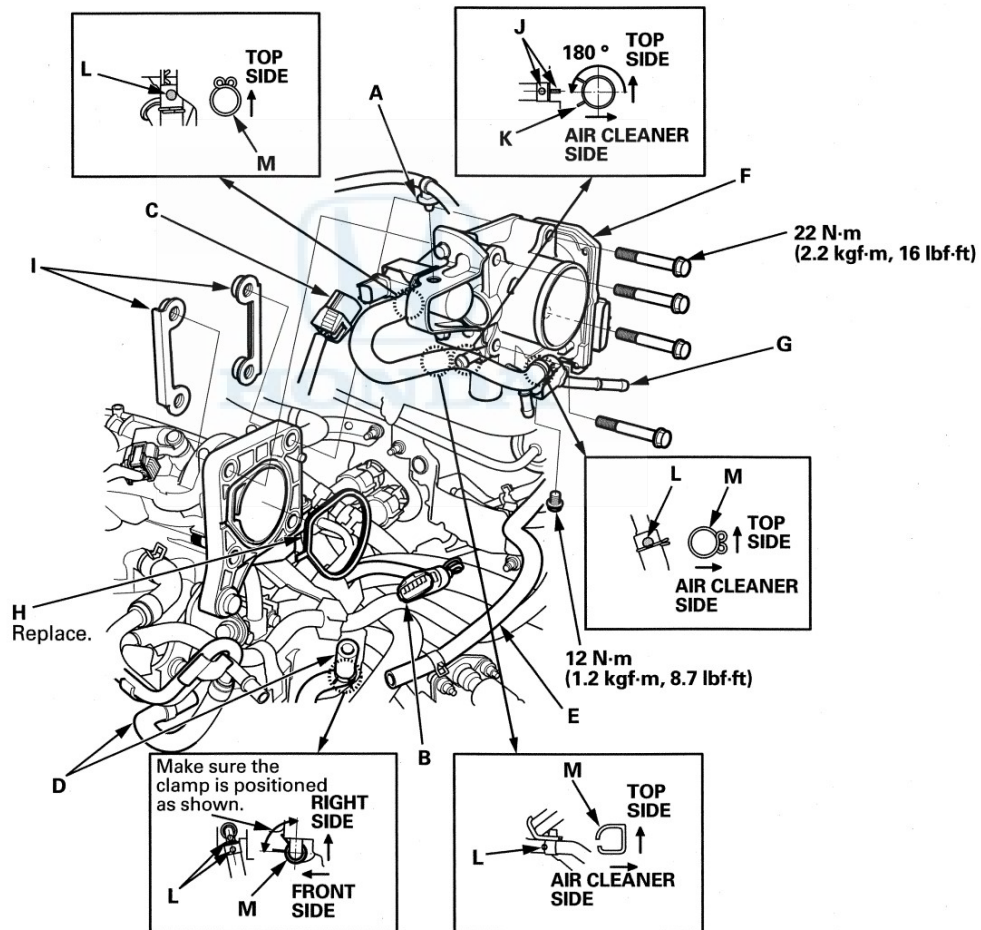

7. Disconnect the throttle body connector (B), and the EVAP canister purge valve connector (C).
8. Disconnect and plug the water bypass hoses (D) and the purge hose (E).
9. Remove the throttle body (F).
10. Remove the purge pipe (G), the water bypass hoses, and the purge hose from the throttle body.

(cont'd)

Intake Air System

Throttle Body Removal/Installation (cont'd)

11. Install the parts in the reverse order of removal with a new gasket (H), then refill the radiator with engine coolant (see page 10-8).

NOTE:

- If you replace or clean the throttle body, go to step 12.
 - If you did not replace or clean the throttle body, this procedure is complete.
 - Be careful not to drop or damage the plates (I).
 - Align the marks (J) on the hose and throttle body, then insert the hose. Make sure the clamp (K) is positioned as shown.
 - Align the mark (L) on the hose as shown, then insert the hose. Make sure the clamp (M) is positioned as shown.
12. Turn the ignition switch to ON (II).
 13. Reset the ECM/PCM with the HDS.
 14. Select the ETCS TEST in the INSPECTION MENU with the HDS.
 15. Select the TP POSITION CHECK, then clear the throttle position (TP) learned value.
 16. Turn the ignition switch to LOCK (0).
 17. Turn the ignition switch to ON (II), and wait 2 seconds without pressing the accelerator pedal.
 18. Do the ECM/PCM idle learn procedure (see page 11-268).