

# Cylinder Head

## Cam Chain Case Oil Seal Installation

### Special Tools Required

- Driver Handle, 15 x 135L 07749-0010000
- Bearing Driver Attachment, 52 x 55 mm 07746-0010400

1. Clean and dry the cam chain case oil seal housing.
2. Apply a light coat of new engine oil to the lip of the cam chain case oil seal.
3. Use the driver handle, 15 x 135L and the bearing driver attachment, 52 x 55 mm to drive a new oil seal squarely into the cam chain case to the specified installed height.

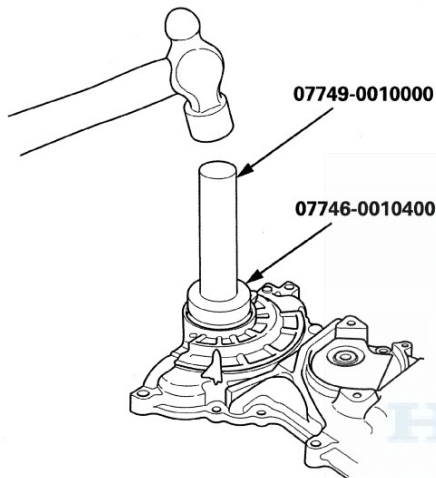

4. Measure the distance between the cam chain case surface and the oil seal.

### Oil Seal Installed Height

30.3–31.0 mm (1.193–1.220 in)

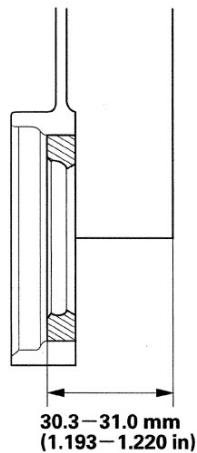

## Cylinder Head Cover Removal

1. Remove the intake manifold chamber (see page 9-3).
2. Disconnect the four ignition coil connectors (A).

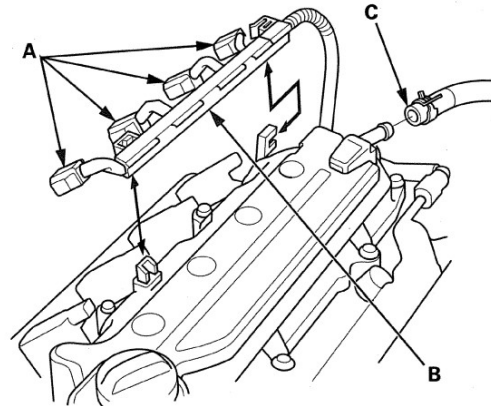

3. Remove the harness holder (B) and the breather hose (C).
4. Remove the cylinder head cover.

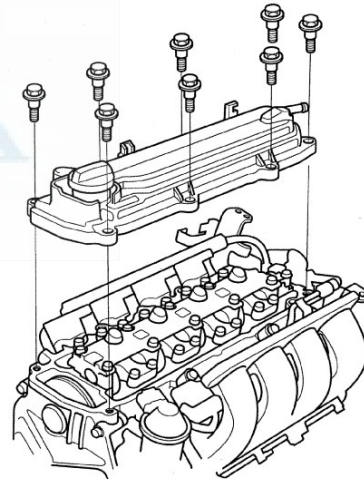



## Cylinder Head Cover Installation

1. Thoroughly clean the head cover gasket and the groove of the cylinder head cover.

**NOTE:** Check and if necessary, replace the head cover gasket.

2. Install the head cover gasket (A) in the groove of the cylinder head cover (B). Make sure the head cover gasket is seated securely.

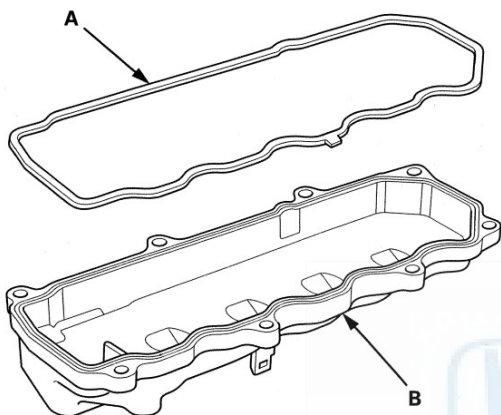

3. Remove all of the old liquid gasket from the cylinder head/cam chain case mating surfaces.
4. Check the head cover contacting surfaces with a shop towel.

5. Apply liquid gasket (P/N 08717-0004, 08718-0003, 08718-0004, or 08718-0009) to the cam chain case contact areas (A). Install the component within 5 minutes of applying the liquid gasket.

**NOTE:**

- Apply a 2.5 mm (0.098 in) diameter bead of liquid gasket to the cam chain case contact areas.
- If you apply liquid gasket P/N 08718-0012, the component must be installed within 4 minutes.
- If too much time has passed after applying the liquid gasket, remove the old liquid gasket and residue, then reapply new liquid gasket.

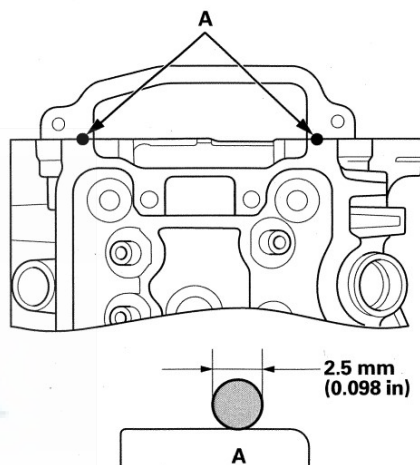

(cont'd)

# Cylinder Head

## Cylinder Head Cover Installation (cont'd)

6. Place the cylinder head cover (A) on the cylinder head, then slide the cover slightly back and forth to seat the head cover gasket.

**NOTE:**

- Wait at least 30 minutes before filling the engine with oil.
- Do not run the engine for at least 3 hours after installing the head cover.

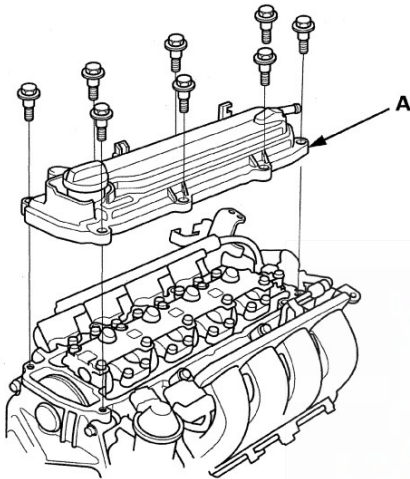

7. Tighten the bolts in three steps. In the final step torque all bolts, in sequence, to 9.8 N·m (1.0 kgf·m, 7 lbf·ft).

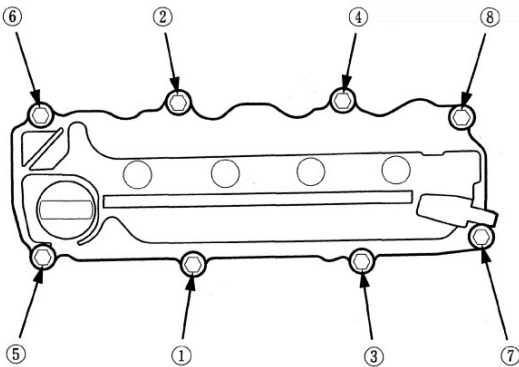

8. Connect the breather hose (A), and install the harness holder (B).

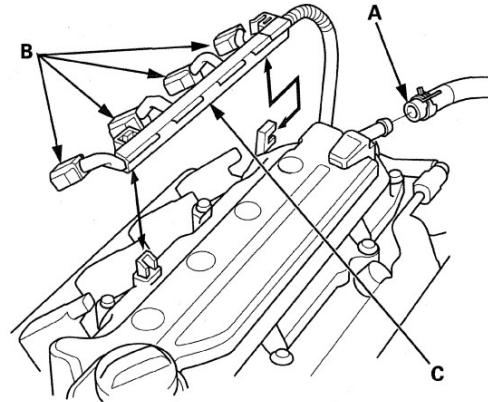

9. Connect the four ignition coil connectors (C).

10. Install the intake manifold chamber (see page 9-4).