

YOUR CURRENT VEHICLE

2015 Honda Fit

Camshaft, VTC Actuator, and Camshaft Sprocket Removal and Installation

NOTE

Applicable vehicles:

- 2015-20 Honda FIT

Camshaft, VTC Actuator, and Camshaft Sprocket Removal and Installation

Removal

NOTE: Keep the cam chain away from magnetic fields.

1. [Cylinder Head Cover - Remove](#)
2. Adjust Screw - Loosen

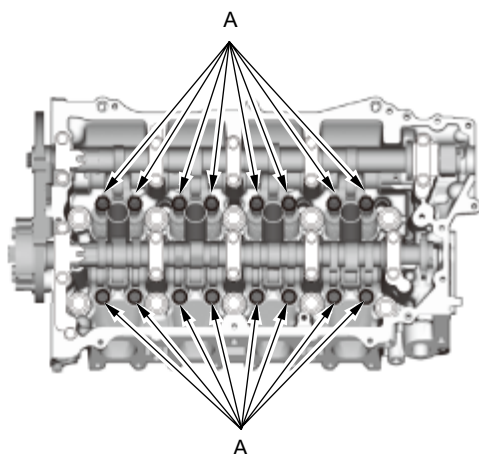

1. Loosen the adjust screws (A).

3. [Cam Chain - Remove](#)

NOTE: After cam chain removal, tighten cam chain guide B mounting bolts to the specified torque.

4. Exhaust Camshaft Sprocket Mounting Bolt - Loosen

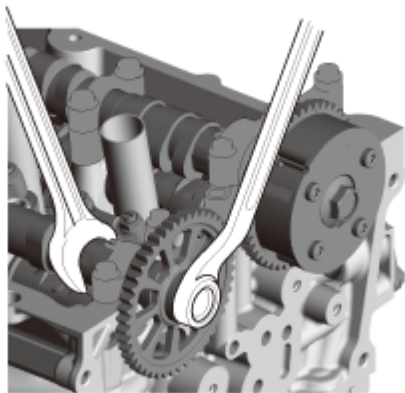

1. Hold the camshaft with an open-end wrench, then loosen the exhaust camshaft sprocket mounting bolt.

5. Exhaust Camshaft Sprocket - Remove

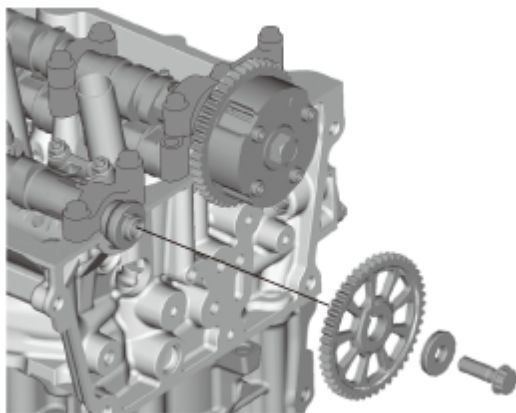

6. Cam Shaft - Remove

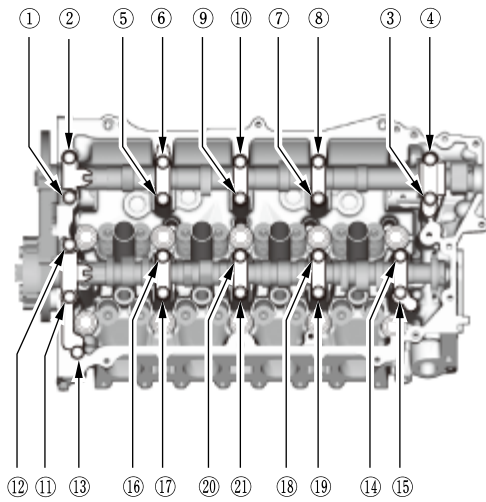

1. Remove the camshaft holder bolts. To prevent damaging the camshafts, loosen the bolts, in sequence, two turns at a time.

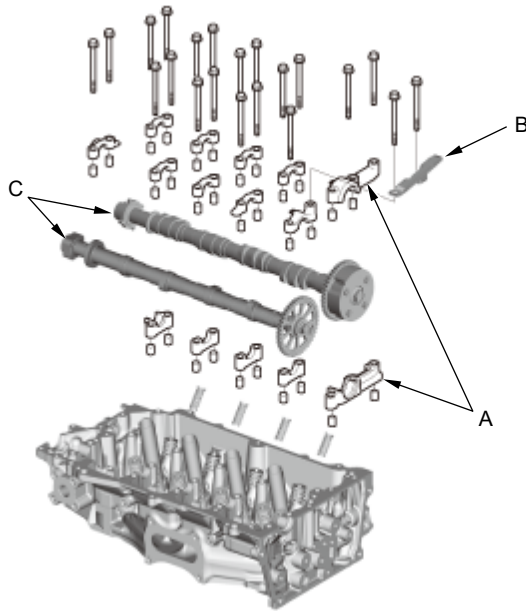

2. Remove the camshaft holders (A), cam chain guide B, and camshafts (C).

7. VTC Actuator Lock Pin - Release

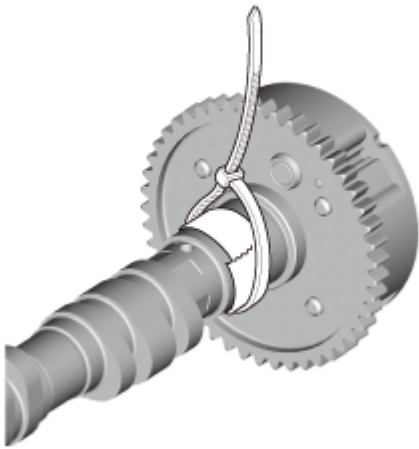
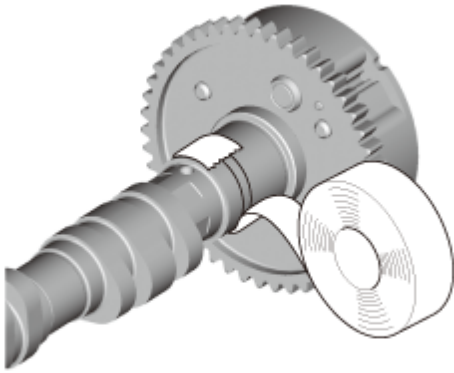

1. Check that the VTC actuator is locked by turning the VTC actuator counterclockwise. If it is not locked, turn the VTC actuator clockwise until it stops, then recheck it. If it is still not locked, replace the VTC actuator.
2. Seal the retard holes in the No. 1 camshaft journal with tape and a wire tie.

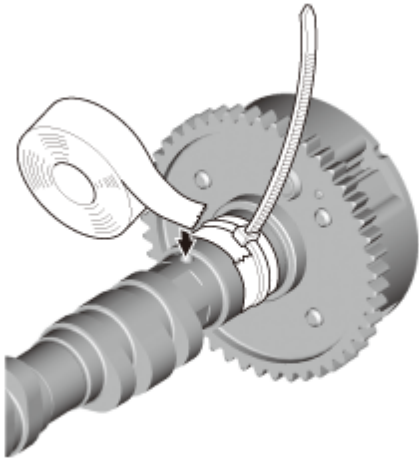

3. Seal one of the advance holes with tape.

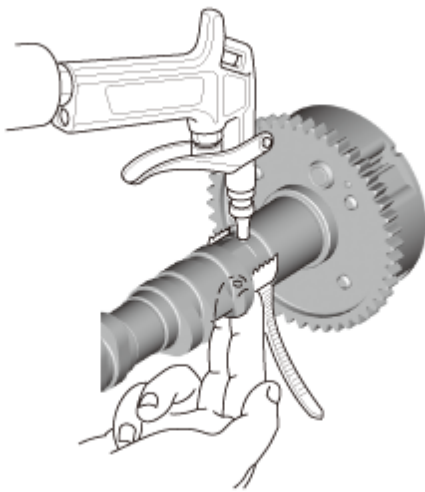

4. Apply air to the unsealed advance hole to release the lock.

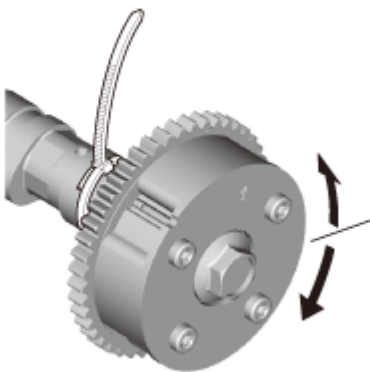

5. Check that the VTC actuator moves smoothly. If the VTC actuator does not move smoothly, replace the VTC actuator.

6. Remove the wire tie, the tape, and the adhesive residue from the camshaft journal.

8. VTC Actuator - Remove

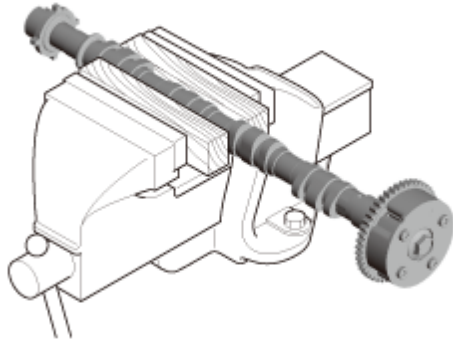

1. Secure the intake camshaft in a vise with wood blocks, then loosen the VTC actuator mounting bolt.

NOTE: After this procedure, remove wood chips that may be stuck to the intake camshaft.

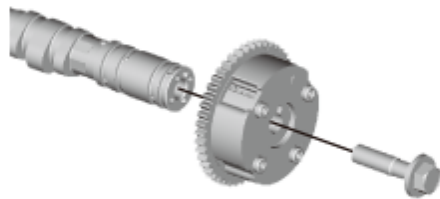

2. Remove the VTC actuator.

Installation

NOTE: Keep the cam chain away from magnetic fields.

1. VTC Actuator - Install

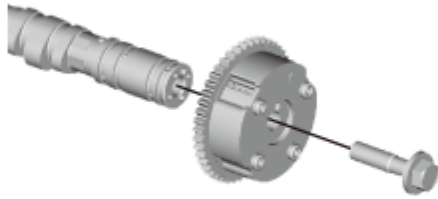

1. Install the VTC actuator.

NOTE: Install the VTC actuator while in the unlocked position.

2. Apply new engine oil to the threads of the VTC actuator mounting bolt, then loosely install them.

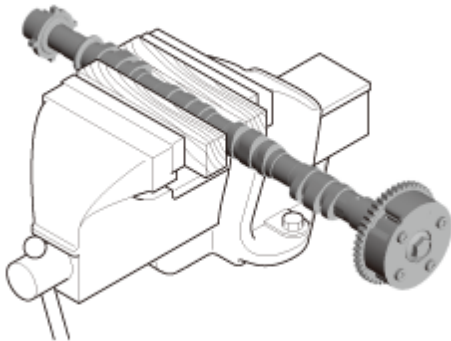

3. Secure the intake camshaft in a vise with wood blocks, then tighten the VTC actuator mounting bolt.

NOTE: After this procedure, remove wood chips that may be stuck to the intake camshaft.

Specified Torque:

115 N·m (11.7 kgf·m, 85 lbf·ft)

4. Turn the VTC actuator clockwise until you hear it click. Make sure to lock the VTC actuator by turning it.

2. Camshaft - Install

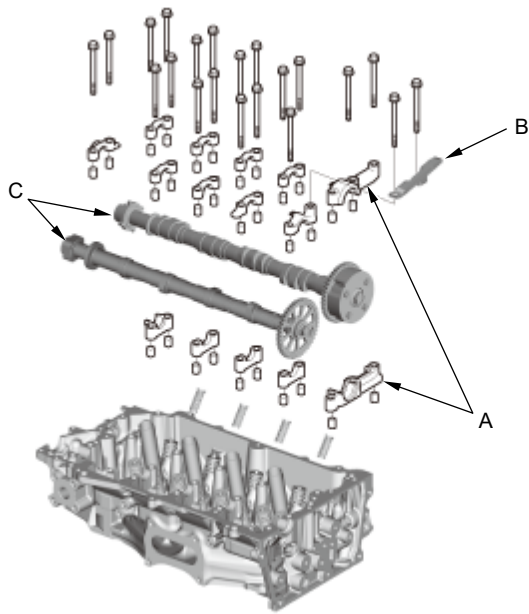

1. Apply new engine oil to the threads of the camshaft holder bolts.
2. Set the camshaft holders (A), the cam chain guide B, and the camshafts (C) in place.

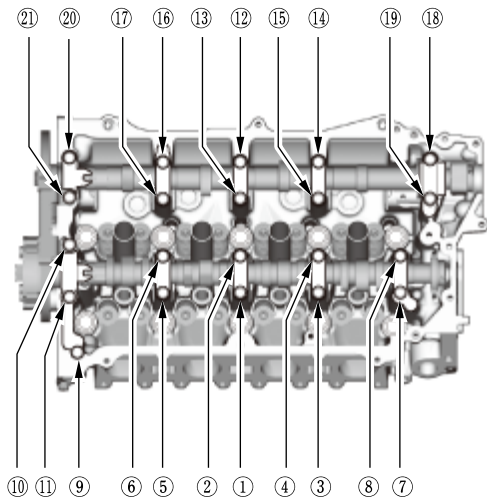

3. Tighten the bolts in the numbered sequence shown.

Specified Torque:

5 N·m (0.5 kgf·m, 4 lbf·ft)

4. Tighten the bolts in the numbered sequence shown.

Specified Torque:

13 N·m (1.3 kgf·m, 10 lbf·ft)

NOTE: After camshaft install, remove cam chain guide B from the camshaft holder.

3. Exhaust Camshaft Sprocket - Install

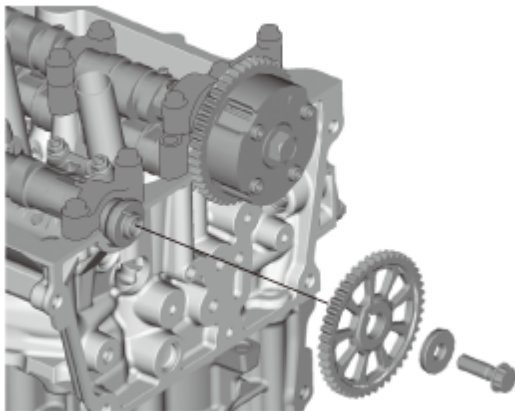

1. Install the exhaust camshaft sprocket.

2. Apply new engine oil to the threads of the exhaust camshaft sprocket mounting bolt, then loosely install them.

4. Exhaust Camshaft Sprocket Mounting Bolt - Tighten

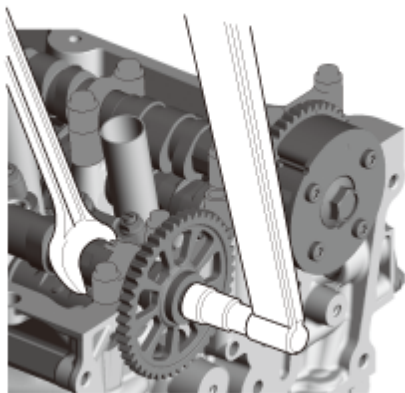

1. Hold the camshaft with an open-end wrench, then tighten the bolt.

Specified Torque:
60 N·m (6.1 kgf·m, 44 lbf·ft)

5. [Cam Chain - Install](#)

6. [Valve Clearance - Adjust](#)

7. [Cylinder Head Cover - Install](#)