

Your Current Vehicle: 2015 Honda Fit

Rate this article: ★ ★ ★ ★ ★

Injector Removal and Installation

NOTE

Applicable vehicles:

- 2015-16 Honda FIT

Injector Removal and Installation

Special Tool Required

Image	Description/Tool Number
 <p>Click to Enlarge</p>	<p>Pick Up Tool 070AC-5A0A100</p>
 <p>Click to Enlarge</p>	<p>Injector Seal Installer Kit 070AG-5A0A100</p>

Removal

NOTE: When replacing the injector, you must replace all **injectors** as an assembly and the fuel joint pipe. Failure to do so will cause poor engine performance and fuel leaks.

1. Fuel Pressure - Relieve
2. Throttle Body - Remove
3. High Pressure Fuel Pump Cover - Remove



4. Fuel Rail Cover - Remove

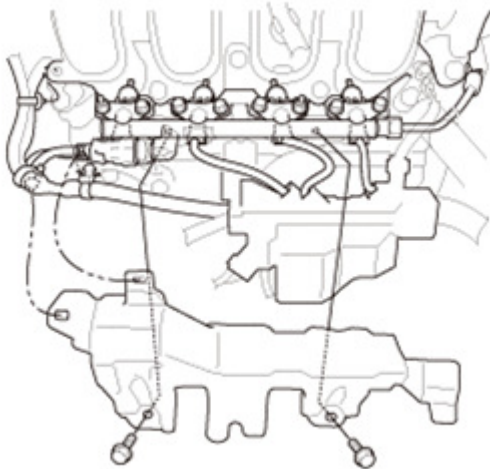

5. Fuel Joint Pipe - Remove

1. Remove the quick-connect fitting cover (A).

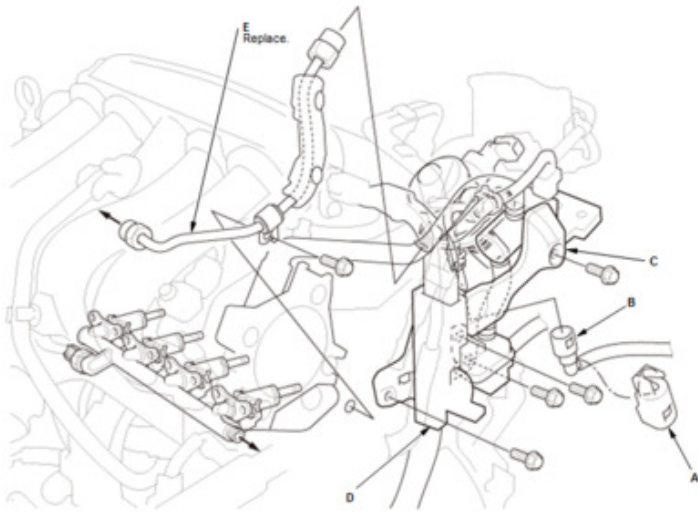

Click to Enlarge

2. Disconnect the quick-connect fitting (B).
3. Remove the fuel joint pipe bracket (C).
4. Move the harness holder (D), and remove the fuel joint pipe (E).

6. Fuel Pipe and Injector - Remove

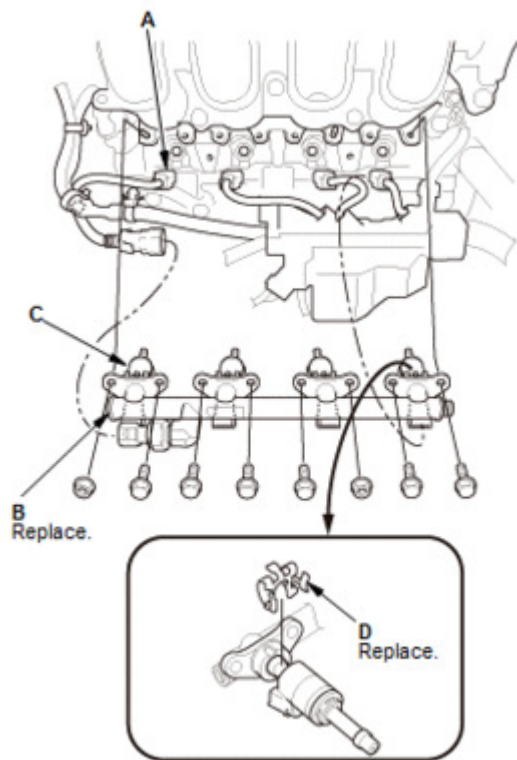

1. Disconnect the connectors (A).
Click to Enlarge
2. Carefully remove the fuel rail (B) with the **injectors** (C) straight from the cylinder head.

NOTE:

- If the injector remains on the cylinder head, carefully remove the injector straight from the cylinder head.
- Note the cylinder number of the injector, and install it to the same cylinder when reinstalling.
- If you replace the injector, the fuel rail, or the cylinder head, use a new injector clip (D).

7. Injector - Remove

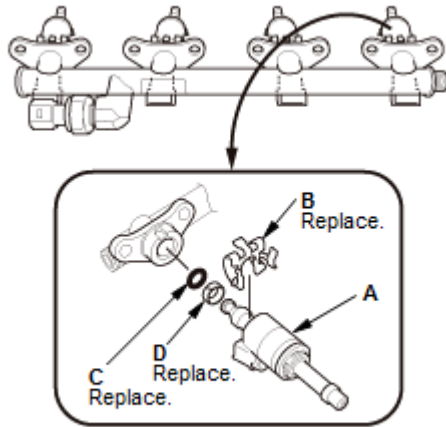

1. Remove the **injectors** (A) from the fuel rail.
2. Remove the injector clip (B), the O-ring (C) and the back-up ring (D) from the injector.

NOTE: If you replace the injector, the fuel rail, or the cylinder head, use a new injector clip, O-ring, and back-up ring.

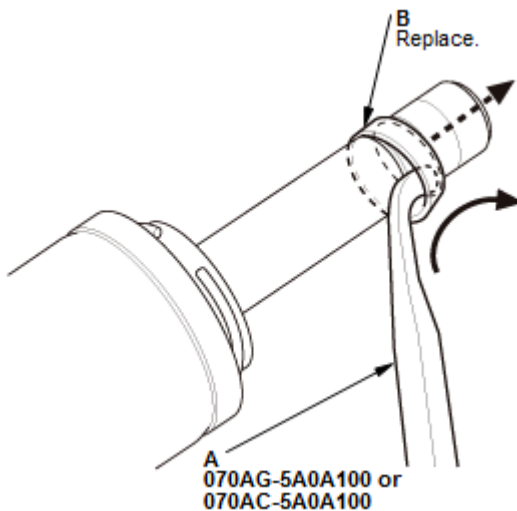

3. Using the pick up tool (A), carefully remove the seal (B) from the injector.

Installation

NOTE: When replacing the injector, you must replace all **injectors** as an assembly and the fuel joint pipe. Failure to do so will cause poor engine performance and fuel

leaks.

1. Injector Seal - Install

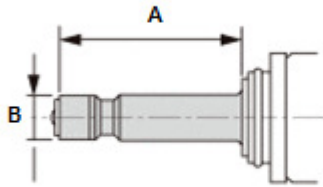

1. With a paper towel, carefully wipe off any carbon from the area (A) shown.

NOTE:

- Do not wipe off the tip area (B) of the injector as it may be damaged.
- If the tip of the injector is dirty or clogged, it must be replaced. The **injectors** cannot be cleaned.

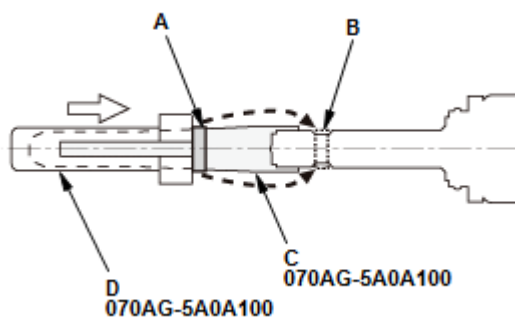

2. Quickly push a new seal (A) down to the groove (B) of the injector using the seal guide tool (C) and the seal installer (D).

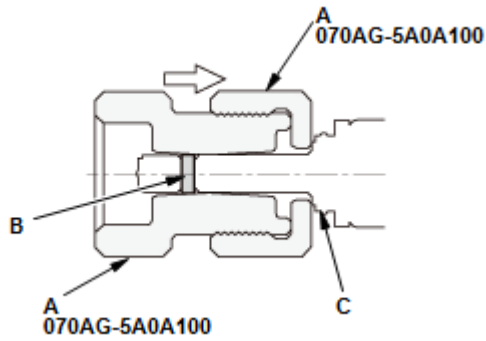

3. Joint the sizing tools (A), then slide them as a set onto the seal (B) until tools touch to the injector stepped surface (C) as shown, and hold the tools to reform the seal for 30 seconds or more.



4. Remove the sizing tool, and check that the seal is installed correctly.

NOTE: When cleaning the sizing tool, be careful not to scratch the sizing tool bore.

2. Injector - Install

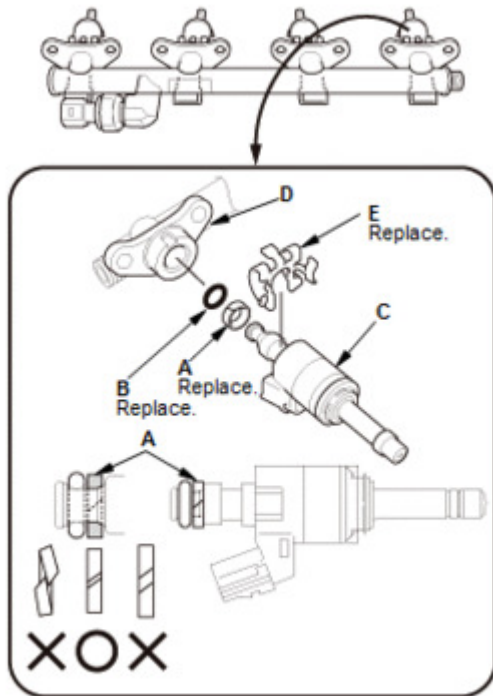

1. Install a new back-up ring (A) and a new O-ring (B) on the injector (C).

NOTE:

- Set the direction of the back-up ring as shown
 - Check that the back-up ring sets correctly after installation.
 - Use compressed air to insure that there are no dust or debris around the ring.
2. Coat the O-ring with clean engine oil, then install the injector onto the fuel rail (D) with a new clip (E).

NOTE: When installing the injector, be sure to protect the injector from dust or debris.

3. Fuel Pipe and Fuel Injector - Install

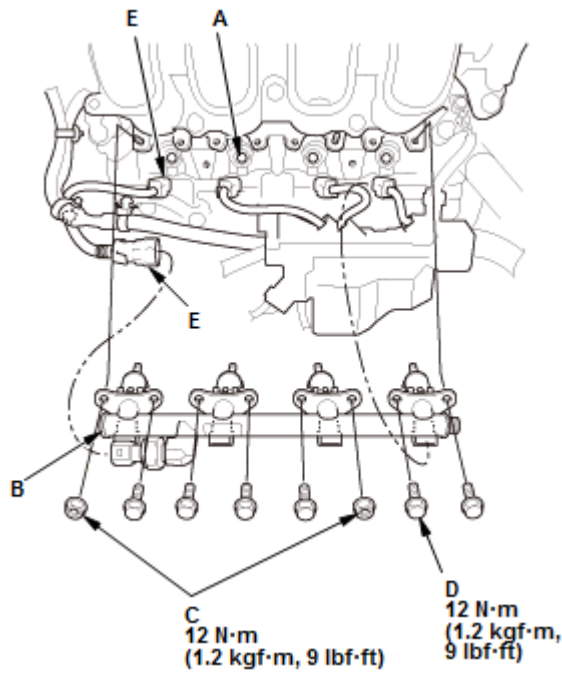

1. Coat the injector holes on the cylinder head (A) with clean engine oil.
2. Carefully install the fuel rail (B) with the **injectors** into the cylinder head straight and equal.

NOTE: When installing the injector, protect the tip of the injector from dust or debris.

3. Install the nuts (C), and tighten them slowly in an alternate pattern until the fuel rail sits on the cylinder head.
4. Tighten the nuts and the bolts (D) to the specified torque.

5. Connect the connectors (E).

4. Fuel Joint Pipe - Install

NOTE:

- Before you install the fuel joint pipe (A), loosen the high pressure fuel pump mounting bolts (B).
- Failure to install a new fuel joint pipe will

cause fuel leaks.

1. Lubricate the top of the new fuel joint pipe (C) and the threaded area (D) of the fuel rail and the high pressure fuel pump with polyethylene glycol in a new fuel joint pipe kit.

NOTE: Do not reuse the fuel joint pipe.

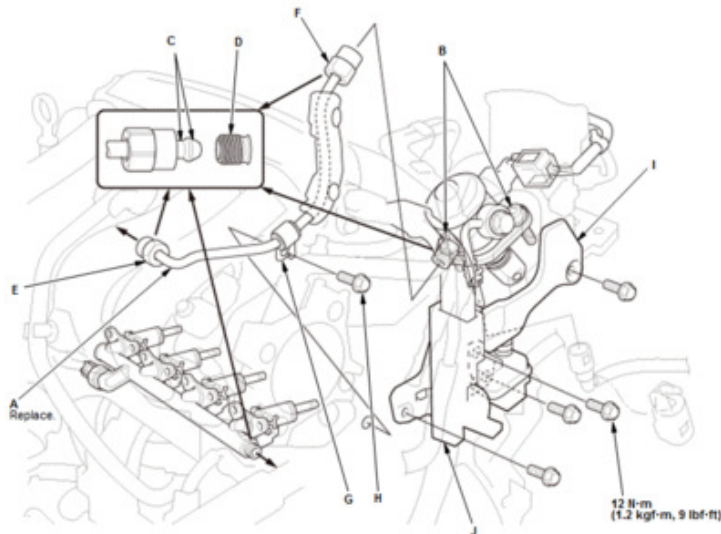

Click to Enlarge

2. Tighten the fuel joint pipe nut (E) by hand until the end of the joint pipe is seated on the fuel rail.
3. Tighten the fuel joint pipe nut (F) by hand until the end of the joint pipe is seated on the high pressure fuel pump.
4. Set the fuel joint pipe bracket (G) to the cylinder head, and loosely install the bolt (H).
5. Install the fuel joint pipe bracket (I), and harness holder (J).
6. Tighten the high pressure fuel pump mounting bolts (A) loosely in an alternate pattern until the high pressure fuel pump

and the cylinder head sitting surfaces are contacted.

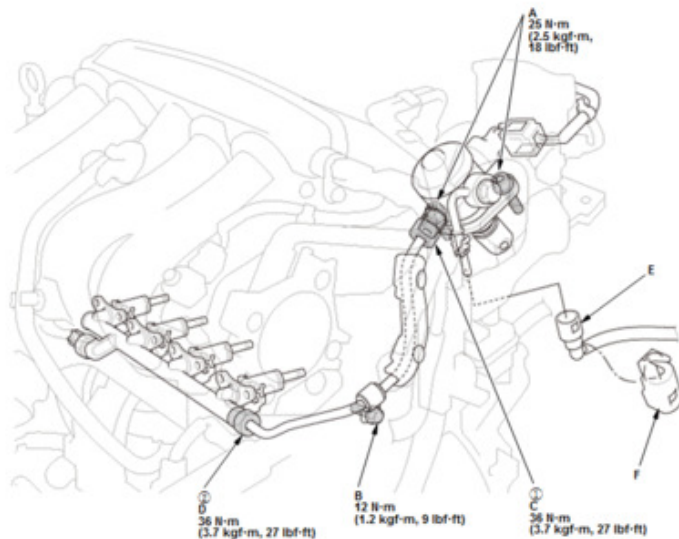

Click to Enlarge

7. Tighten the high pressure fuel pump mounting bolts to the specified torque.
8. Tighten the fuel joint pipe bracket mounting bolt (B) to the specified torque.
9. Tighten the high pressure fuel pump side of the fuel joint pipe nut (C) and the fuel rail side of the fuel joint pipe nut (D) to the specified torque in the numbered sequence shown.

NOTE: A crowfoot-type special tool increases the torque applied by the torque wrench. Refer to Torque Specifications for details on how to recalculate the torque wrench setting.

10. Connect the quick-connect fitting (E) and install the quick-connect fitting cover (F).

5. Fuel Leak (Low Pressure Side) - Check

1. Turn the vehicle to the ON mode, but do not start the engine. After the fuel pump runs for about 2 seconds, the fuel line will be

pressurized. Repeat this two or three times, then check for fuel leakage.

6. Fuel Leak (High Pressure Side) - Check

7. Fuel Rail Cover - Install

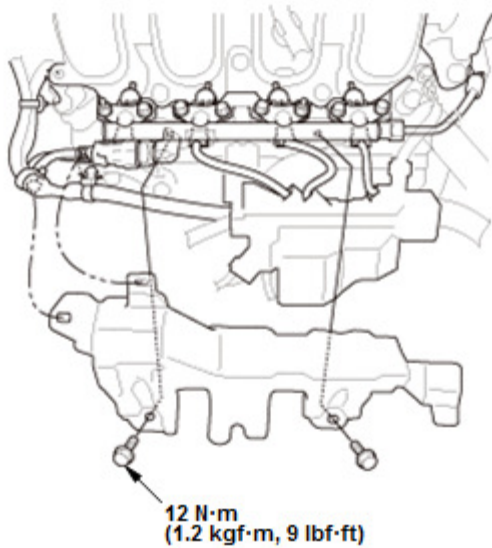

8. High Pressure Fuel Pump Cover - Install



9. Throttle Body - Install

Copyright ©2019 by Chilton, an imprint of Cengage Learning

[\(/lh/Home/Index/mwellxAGtxhL3dx6R1djNI3IEoLmcC85WRVan_xLfAfQOZCk1\)Home](#)

[Terms and Conditions \(//www.cengage.com/content/footer/terms_of_use.aspx\)](#)

[Privacy Statement \(//www.cengage.com/content/footer/privacy_statement.aspx\)](#)

[Contact Us \(//www.cengage.com/contact/\)](#)

