

# Parking Brake Inspection and Adjustment

**NOTE**

Applicable vehicles:

- 2015-16 Honda FIT

## Parking Brake Inspection and Adjustment

**Inspection**

1. Parking Brake - Inspect

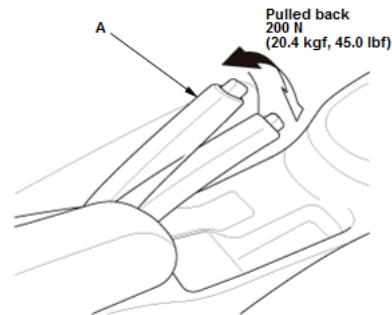

1. Pull the parking brake lever (A) with 200 N (20.4 kgf, 45.0 lbf) of force to fully apply the parking brake.

2. The parking brake lever should be locked within the specified number of clicks.

**Lever locked clicks: 8 to 10 clicks**

3. Adjust the parking brake if the lever clicks are not within the specification.

**Adjustment**

**NOTE:** After servicing the rear brake shoes, loosen the parking brake adjusting nut, start the engine, and press the brake pedal several times to set the self-adjusting brake before adjusting the parking brake.

1. Vehicle - Lift
2. Parking Brake - Release
3. Center Console - Remove (Without Center Console Armrest Type)
4. Center Console Rear Trim - Remove (With Center Console Armrest Type)
5. Parking Brake - Adjust

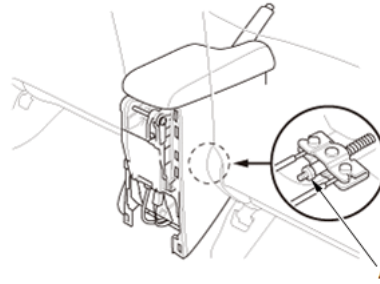

This illustration shows with center console armrest type.

1. Loosen the parking brake adjusting nut (A).
  2. Pull the parking brake lever 1 click.
  3. Tighten the adjusting nut until the parking brakes drag slightly when the rear wheels are turned.
  4. Release the parking brake lever fully.
  5. Check that the parking brakes do not drag when the rear wheels are turned. Readjust if necessary.
  6. Make sure the parking brake lever is within the specified number of clicks (8 to 10 clicks).
6. Center Console - Install (Without Center Console Armrest Type)
  7. Center Console Rear Trim - Install (With Center Console Armrest Type)

Copyright ©2019 by Chilton, an imprint of Cengage Learning

(/lh/Home/Index/mwellK5l3k-laFvzC0JZWcYgR34HGJbtceEDcv-Ty9DIyUls1)Home

Terms and Conditions (/www.cengage.com/content/footer/terms\_of\_use.aspx)

Privacy Statement (/www.cengage.com/content/footer/privacy\_statement.aspx) Contact Us (/www.cengage.com/contact/)

